

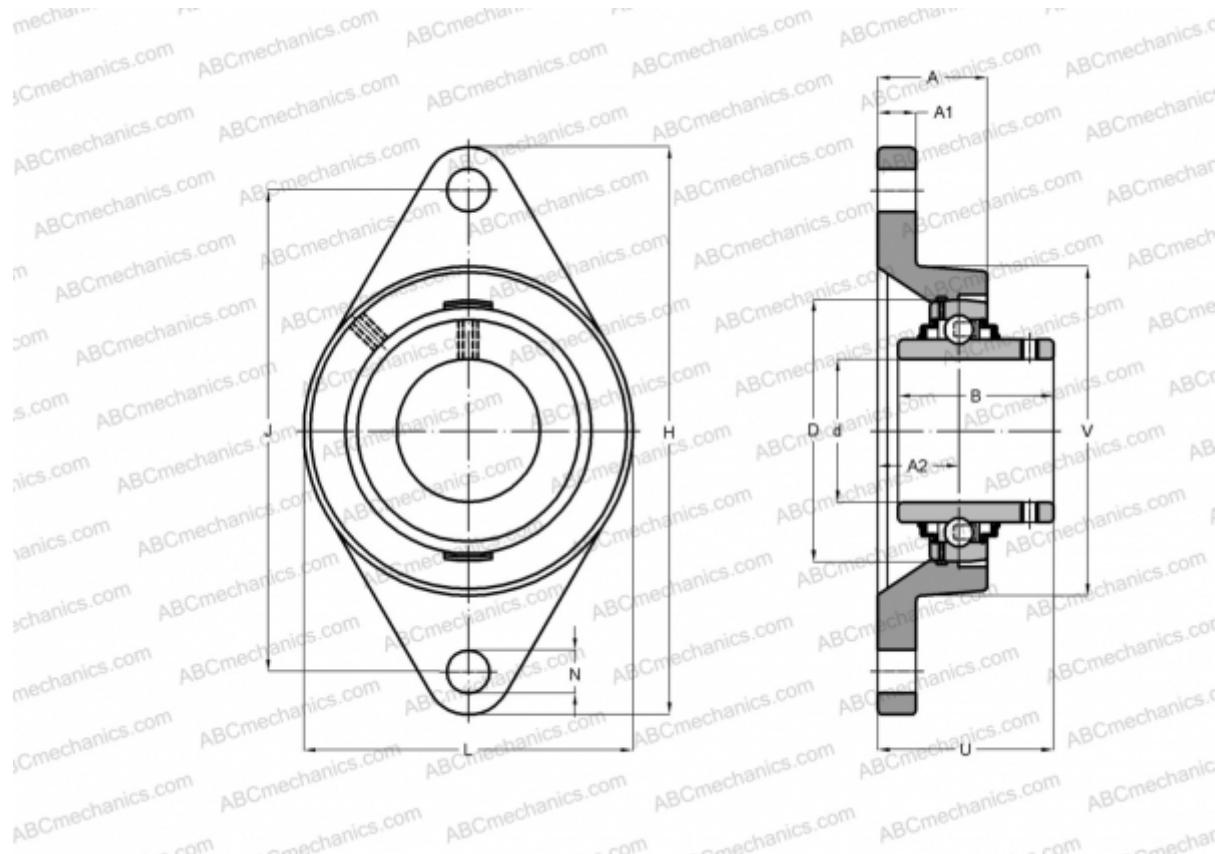

RCJTY35-JIS INA

Ball bearing units

TYPE: Housing units, Two-bolt flanged housing units, Cast iron housing, Radial insert ball bearing with grub screws in inner ring, Type RCJTY (INA), dimensions sizes by standard JIS B 1559



Technical specification

DIMENSIONS, MM

d	35,000
D	72,000
B	42,900
L	90,000
H	161,000
A	34,000
J	130,000
A1	16,000
A2	19,000
N	16,000
U	44,400
Q	M6

WEIGHT, KG 1,190

Bearing	GYE35-KRR-B-
Housing	GG.FL207

MANUFACTURER

[INA](#)

CALCULATION DATA

Basic dynamic load rating, C	25,500 kN
Basic static load rating, Co	15,300 kN