

RCJTY45-JIS INA

Ball bearing units

TYPE: Housing units, Two-bolt flanged housing units, Cast iron housing, Radial insert ball bearing with grub screws in inner ring, Type RCJTY (INA), dimensions sizes by standard JIS B 1559

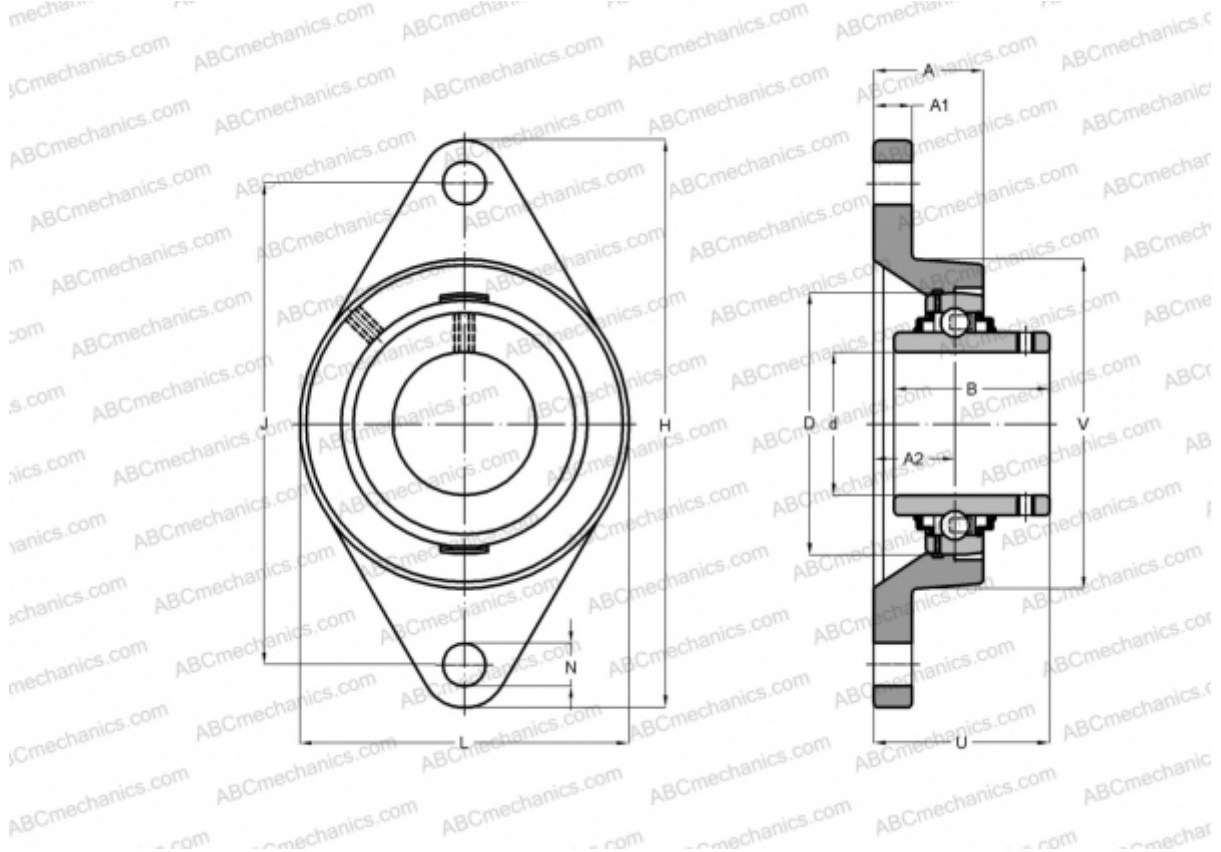

Technical specification

DIMENSIONS, MM

d	45,000
D	85,000
B	49,200
L	108,000
H	188,000
A	38,000
J	148,000
A1	18,000
A2	22,000
N	19,000
U	52,200
Q	M6

WEIGHT, KG 1,940

Bearing	GYE45-KRR-B-
Housing	GG.FL209

MANUFACTURER

[INA](#)

CALCULATION DATA

Basic dynamic load rating, C	32,500 kN
Basic static load rating, Co	20,400 kN