

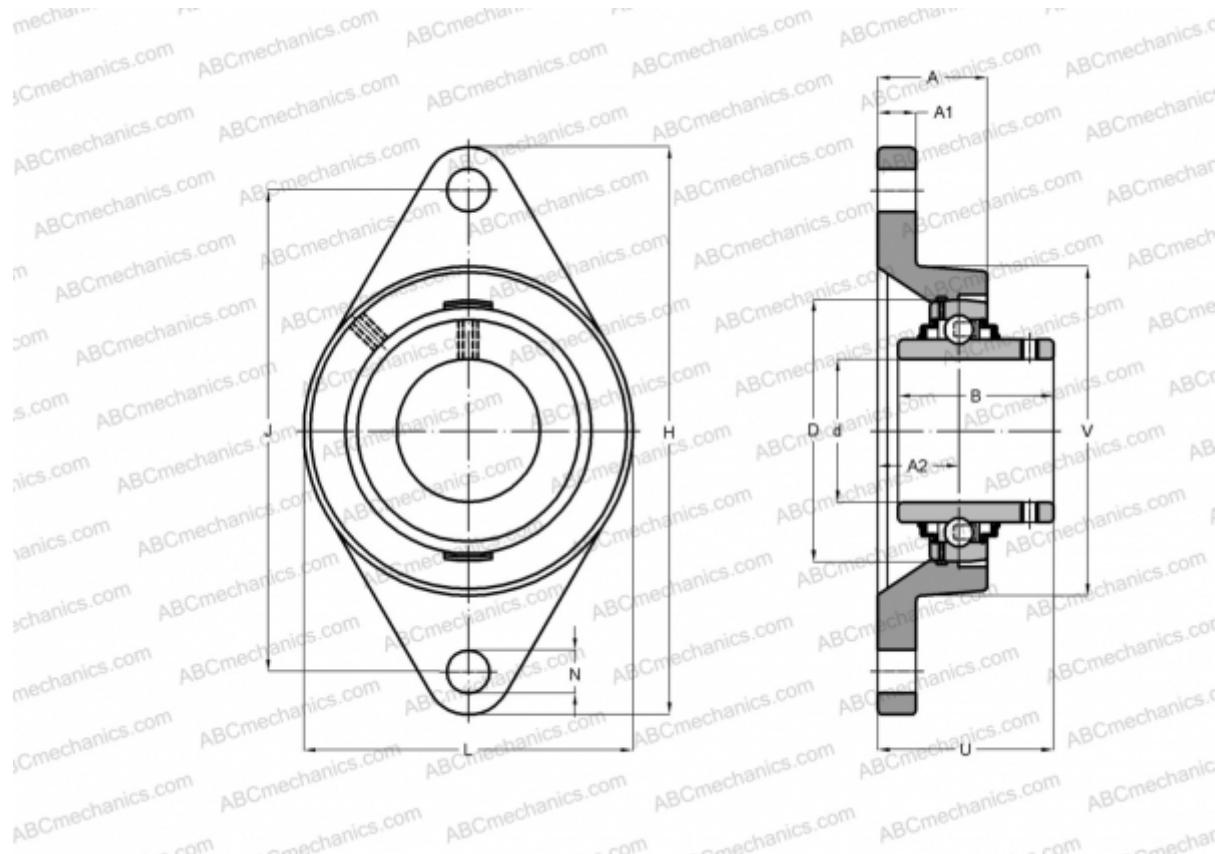

## RCJTY50-JIS INA

Ball bearing units

TYPE: Housing units, Two-bolt flanged housing units, Cast iron housing, Radial insert ball bearing with grub screws in inner ring, Type RCJTY (INA), dimensions sizes by standard JIS B 1559



### Technical specification

#### DIMENSIONS, MM

d	50,000
D	90,000
B	51,600
L	115,000
H	197,000
A	40,000
J	157,000
A1	18,000
A2	22,000
N	19,000
U	54,600
Q	M6

**WEIGHT, KG** 2,210

Bearing	GYE50-KRR-B-
Housing	GG.FL210

#### MANUFACTURER

[INA](#)

#### CALCULATION DATA

Basic dynamic load rating, C	35,000 kN
Basic static load rating, Co	23,200 kN