

RCJTY55-JIS INA

Ball bearing units

TYPE: Housing units, Two-bolt flanged housing units, Cast iron housing, Radial insert ball bearing with grub screws in inner ring, Type RCJTY (INA), dimensions sizes by standard JIS B 1559

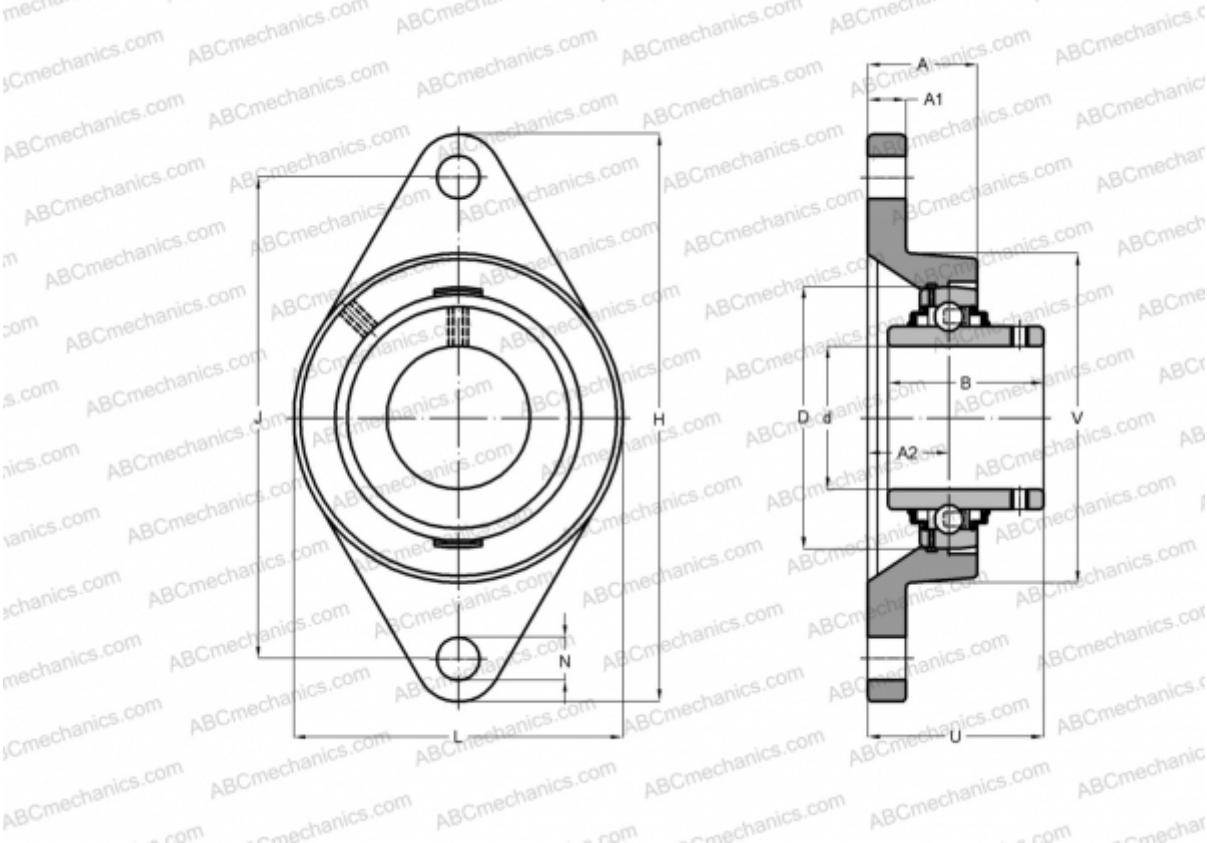

Technical specification

DIMENSIONS, MM	
d	55,000
D	100,000
B	55,600
L	130,000
H	224,000
A	43,000
J	184,000
A1	20,000
A2	25,000
N	19,000
U	58,400
Q	M6
WEIGHT, KG	2,830

Bearing	GYE55-KRR-B-
Housing	GG.FL211

MANUFACTURER [INA](#)

CALCULATION DATA	
Basic dynamic load rating, C	43,500 kN
Basic static load rating, Co	29,000 kN