

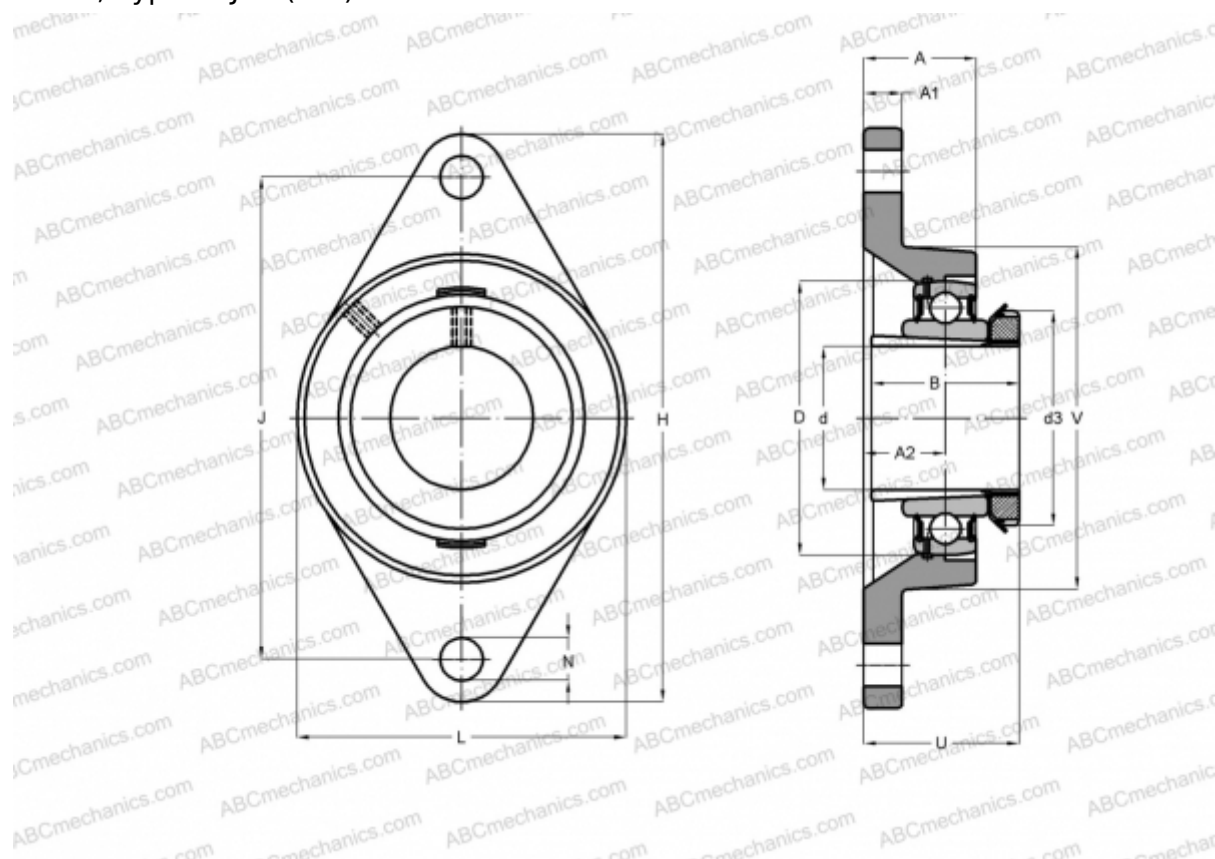

RCJTA25-N INA

Ball bearing units

TYPE: Housing units, Two-bolt flanged housing units, Cast iron housing, Radial insert ball bearing with adapter sleeve, Type RCJTA (INA)



Technical specification

DIMENSIONS, MM

d	25,000
D	52,000
B	28,000
L	70,000
H	124,000
A	26,500
J	99,000
A1	11,000
A2	19,000
N	11,500
d3	38,000
U	42,500
V	70,000
Q	Rp1/8

WEIGHT, KG

0,540

Bearing	GSH25-2RSR-B
Housing	GG.CJT05-N
Protective cover	KASK05

MANUFACTURER

[INA](#)

CALCULATION DATA

Basic dynamic load rating, C	13,600 kN
Basic static load rating, Co	7,800 kN