

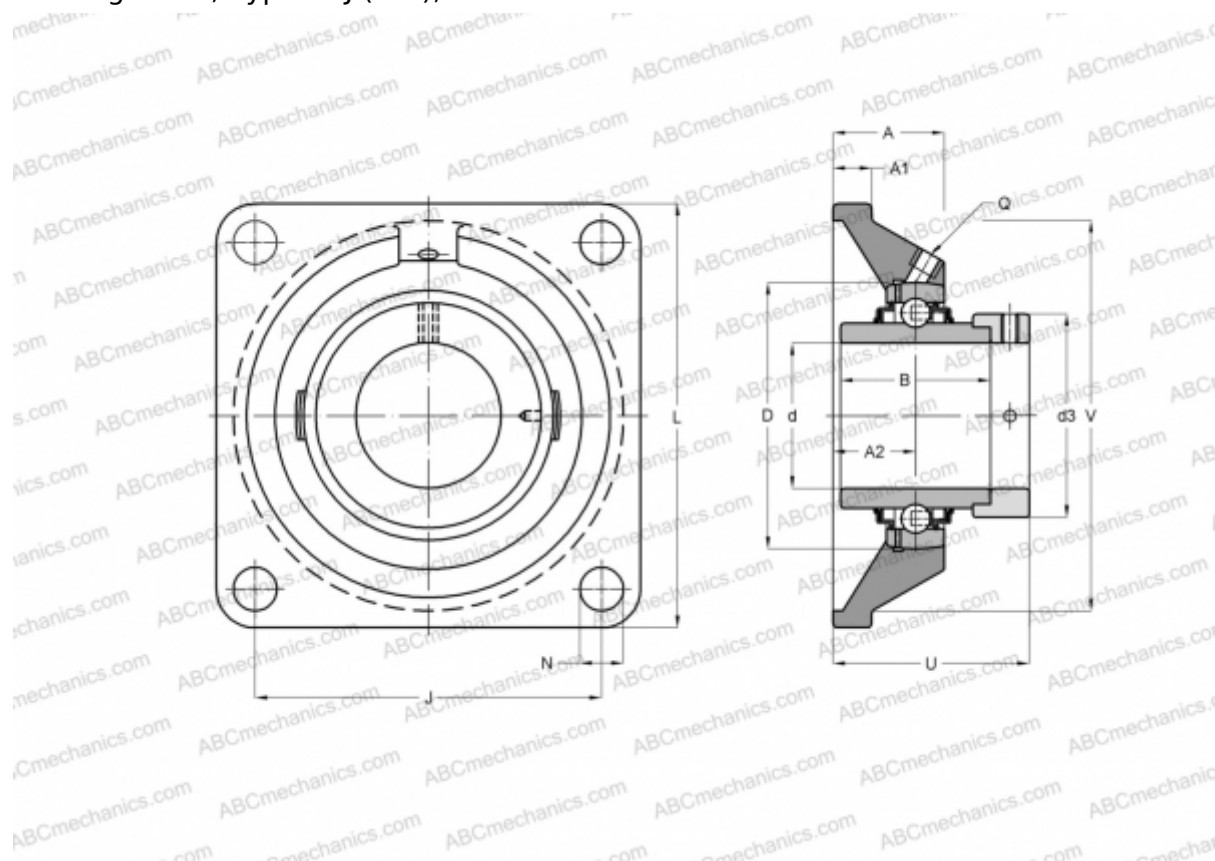

RCJ45-FA125 INA

Ball bearing units

TYPE: Housing units, Four-bolt flanged housing units, Cast iron housing, Radial insert ball bearing with eccentric locking collar, Type RCJ (INA), coated with CORROTECT



Technical specification

DIMENSIONS, MM

d	45,000
D	85,000
B	56,500
L	137,000
A	35,000
J	105,000
A1	13,000
A2	24,000
N	14,000
d3	63,000
U	59,100
V	116,000
Q	Rp1/8

Bearing	GE45-KRR-B-
Housing	GG.CJ09-

FA125.1

MANUFACTURER

[INA](#)

CALCULATION DATA

Basic dynamic load rating, C	32,500 kN
Basic static load rating, Co	20,400 kN

WEIGHT, KG	2,260
------------	-------