

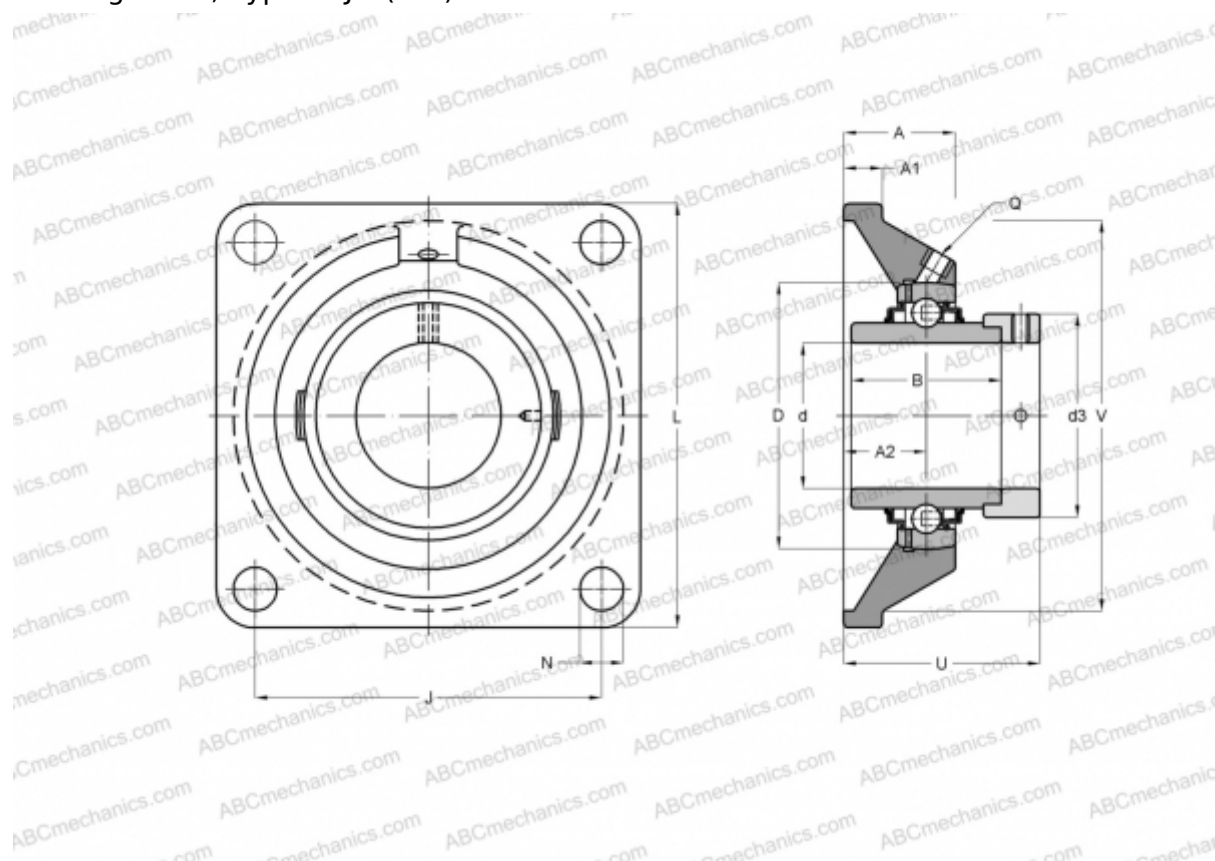

## RCJO40 INA

Ball bearing units

TYPE: Housing units, Four-bolt flanged housing units, Cast iron housing, Radial insert ball bearing with eccentric locking collar, Type RCJO (INA)



### Technical specification

#### DIMENSIONS, MM

d	40,000
D	90,000
B	54,600
L	150,000
A	34,500
J	112,000
A1	17,000
A2	23,000
N	19,000
d3	63,000
U	59,600
V	121,000
Q	Rp1/8

**WEIGHT, KG** 3,100

Bearing	GN40-KRR-B
Housing	GG.CJO08

#### MANUFACTURER

[INA](#)

#### CALCULATION DATA

Basic dynamic load rating, C	44,500 kN
Basic static load rating, Co	26,000 kN