

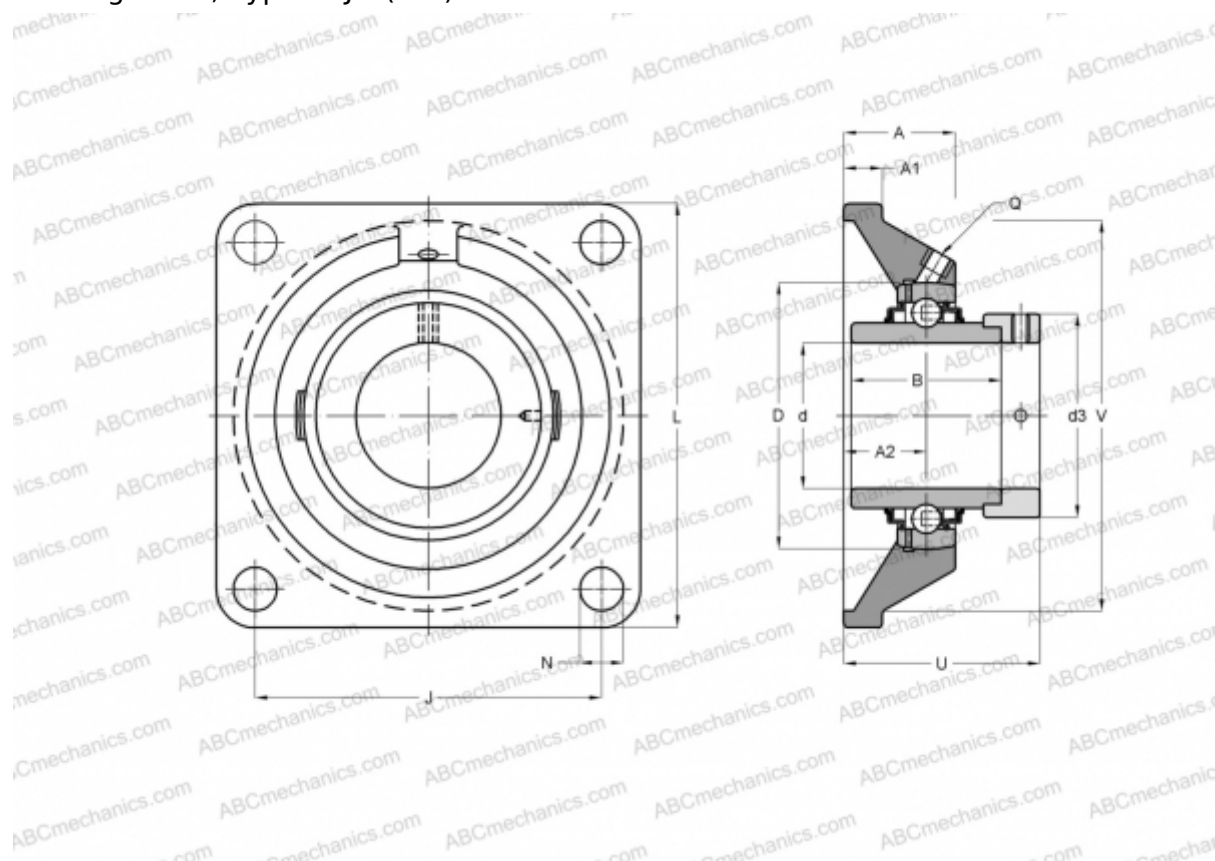

RCJO60 INA

Ball bearing units

TYPE: Housing units, Four-bolt flanged housing units, Cast iron housing, Radial insert ball bearing with eccentric locking collar, Type RCJO (INA)



Technical specification

DIMENSIONS, MM

d	60,000
D	130,000
B	68,400
L	195,000
A	49,500
J	150,000
A1	22,000
A2	33,000
N	23,000
d3	89,000
U	78,400
V	170,000
Q	Rp1/8

WEIGHT, KG 6,800

Bearing	GNE60-KRR-B
Housing	GG.CJO12

MANUFACTURER

[INA](#)

CALCULATION DATA

Basic dynamic load rating, C	82,000 kN
Basic static load rating, Co	52,000 kN