

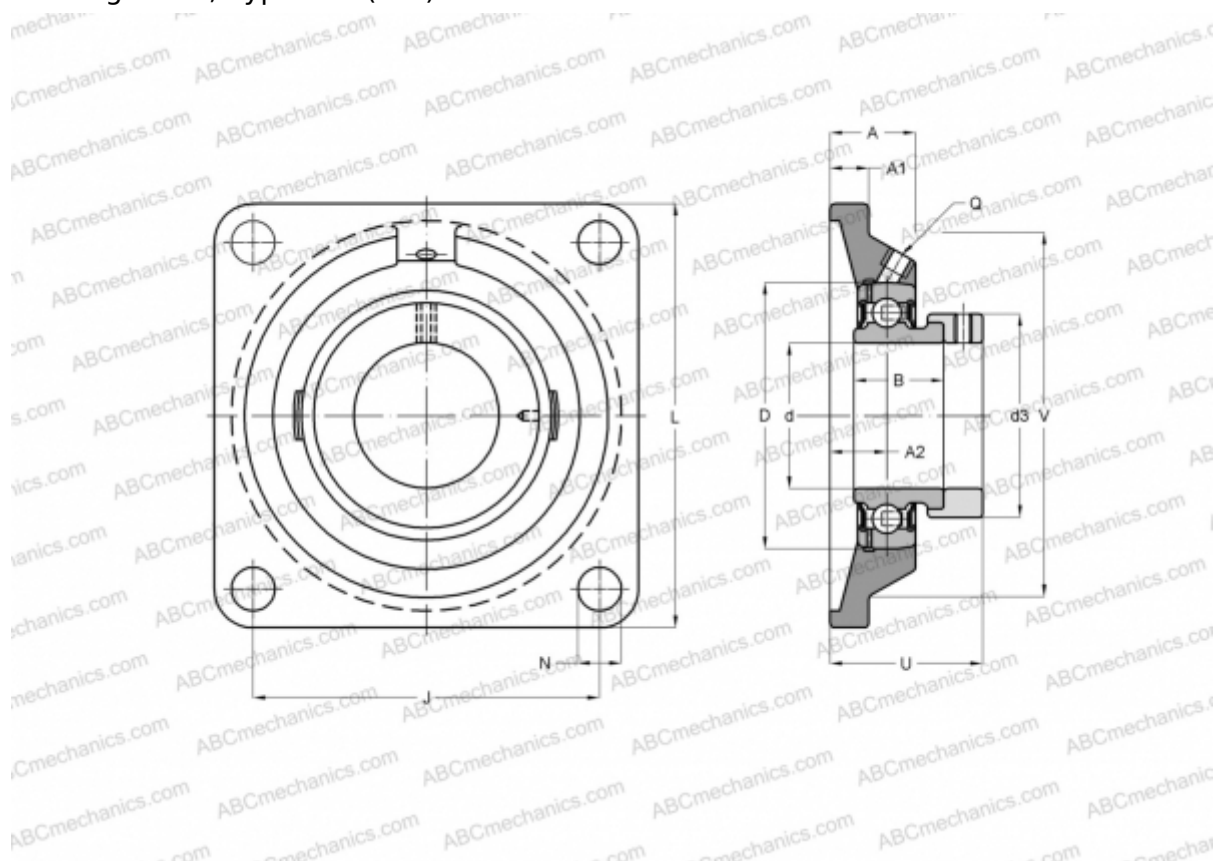

PCF50 INA

Ball bearing units

TYPE: Housing units, Four-bolt flanged housing units, Cast iron housing, Radial insert ball bearing with eccentric locking collar, Type PCF (INA)



Technical specification

DIMENSIONS, MM

d	50,000
D	90,000
B	43,800
L	143,000
A	30,200
J	111,000
A1	13,000
A2	19,200
N	14,000
d3	69,000
U	51,400
V	125,000
Q	Rp1/8

WEIGHT, KG 2,200

Bearing	GRAE50-NPP-B
Housing	GG.CF10

MANUFACTURER

[INA](#)

CALCULATION DATA

Basic dynamic load rating, C	35,000 kN
Basic static load rating, Co	23,200 kN

