

PME25-N INA

Ball bearing units

TYPE: Housing units, Four-bolt flanged housing units, Cast iron housing, Radial insert ball bearing with eccentric locking collar, Centring spigot, type PME (INA)

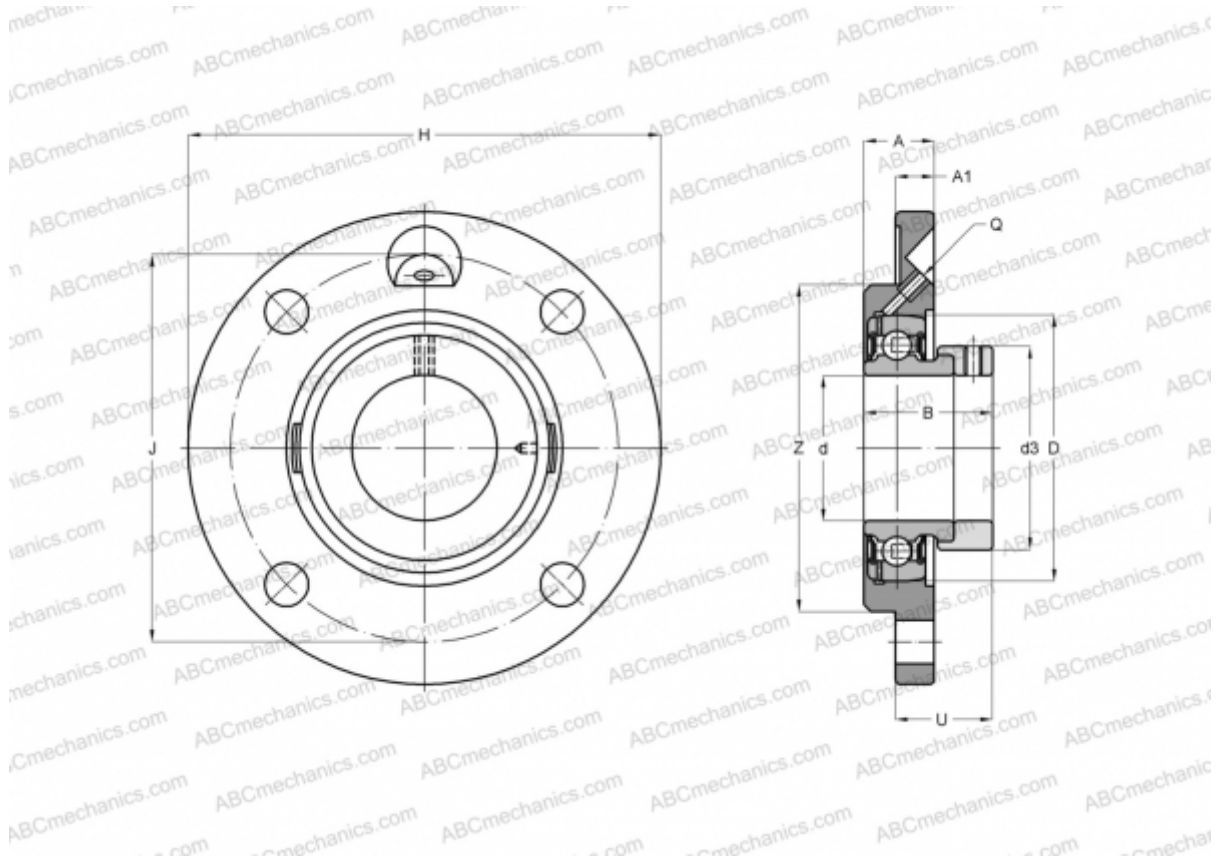

Technical specification

DIMENSIONS, MM

d	25,000
D	52,000
B	31,000
H	115,000
A	19,000
J	90,000
A1	9,000
N	9,000
d3	37,500
U	21,000
Z	70,000
Q	M6

WEIGHT, KG 0,730

Bearing	GRAE25-NPP-B
Housing	GG.ME05-N
Protective cover	KASK05

MANUFACTURER

[INA](#)

CALCULATION DATA

Basic dynamic load rating, C	14,000 kN
Basic static load rating, Co	7,800 kN