

## PME35-N INA

Ball bearing units

TYPE: Housing units, Four-bolt flanged housing units, Cast iron housing, Radial insert ball bearing with eccentric locking collar, Centring spigot, type PME (INA)

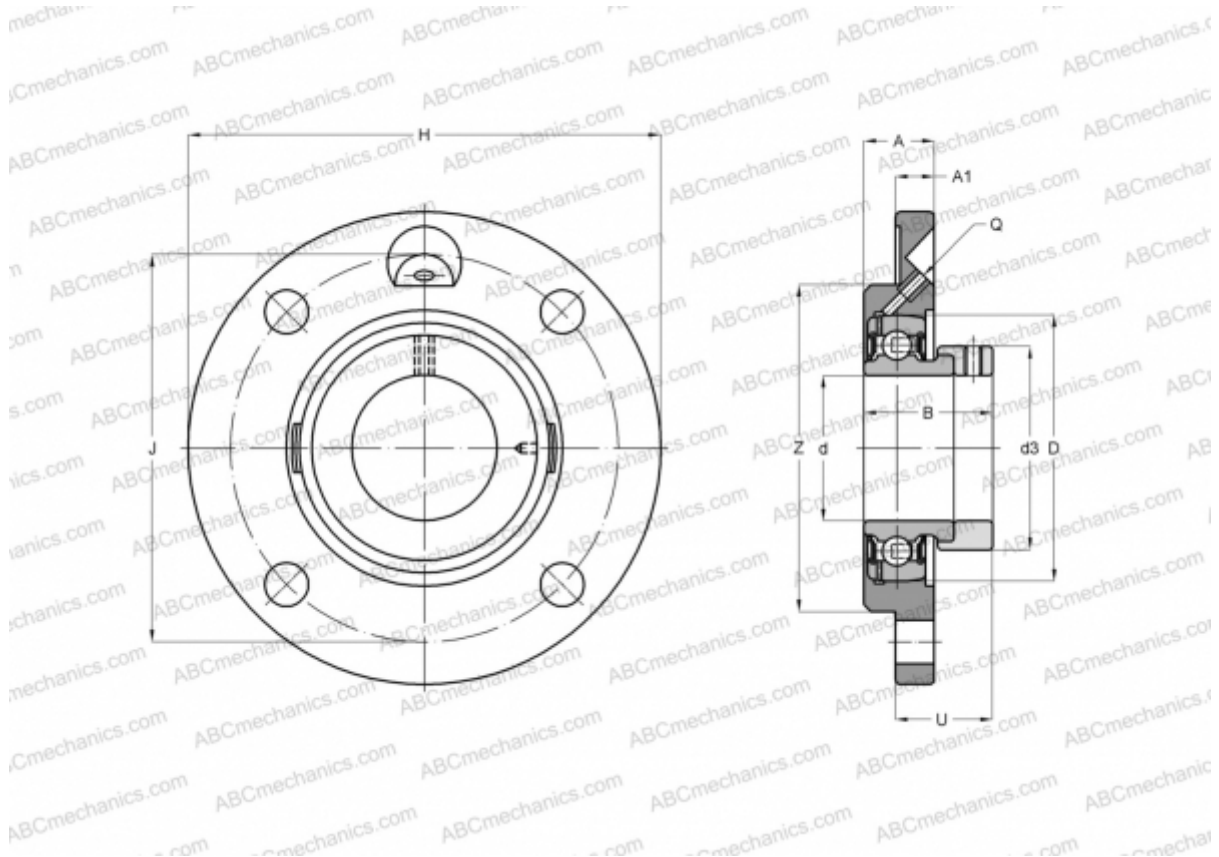

### Technical specification

#### DIMENSIONS, MM

d	35,000
D	72,000
B	39,000
H	135,000
A	20,500
J	110,000
A1	10,000
N	11,500
d3	51,000
U	28,500
Z	90,000
Q	M6

**WEIGHT, KG** 1,220

Bearing	GRAE35-NPP-B
Housing	GG.ME07-N
Protective cover	KASK07

#### MANUFACTURER

[INA](#)

#### CALCULATION DATA

Basic dynamic load rating, C	25,500 kN
Basic static load rating, Co	15,300 kN