

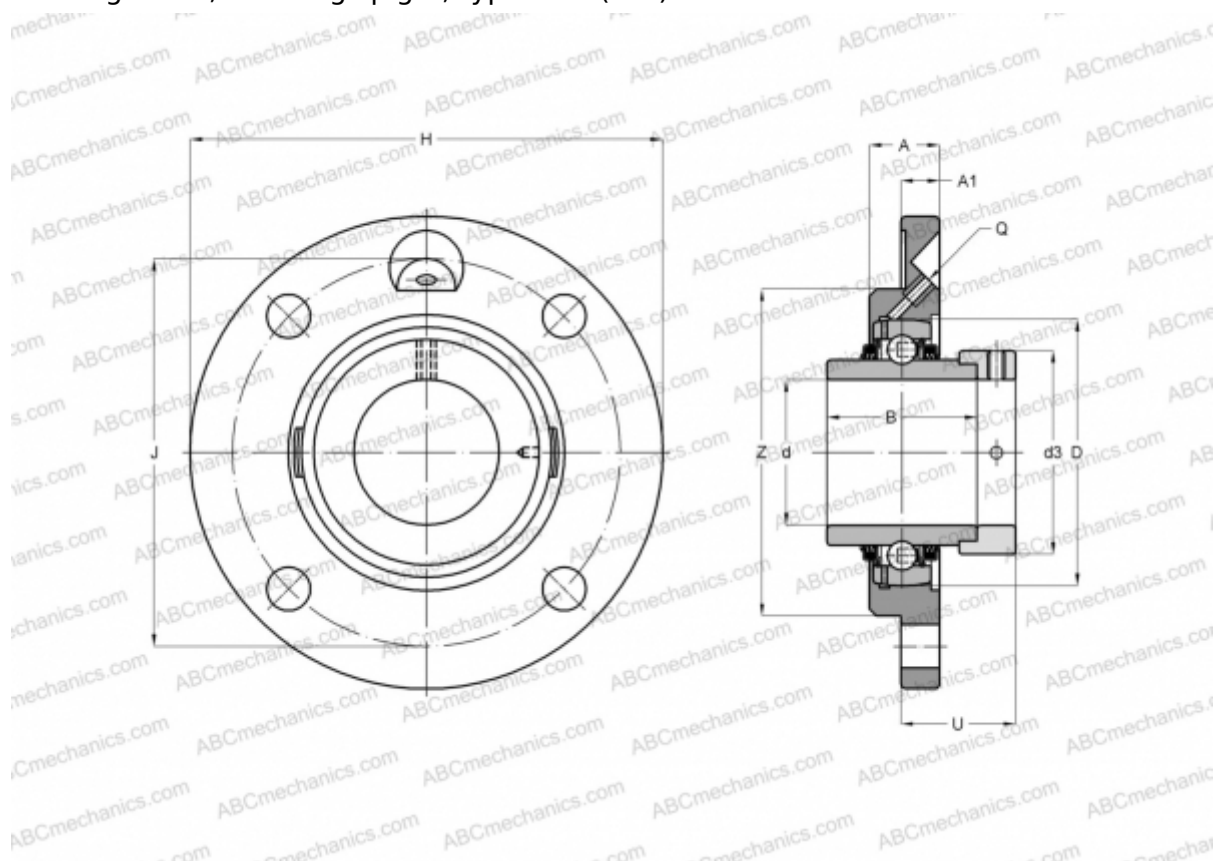

TME50-N INA

Ball bearing units

TYPE: Housing units, Four-bolt flanged housing units, Cast iron housing, Radial insert ball bearing with eccentric locking collar, Centring spigot, type TME (INA)



Technical specification

DIMENSIONS, MM

d	50,000
D	90,000
B	62,800
H	165,000
A	25,000
J	135,000
A1	13,000
N	14,000
d3	69,000
U	37,100
Z	110,000
Q	M8X1

WEIGHT, KG 2,590

Bearing	GE50-KTT-B
Housing	GG.ME10-N
Protective cover	KASK10

MANUFACTURER

[INA](#)

CALCULATION DATA

Basic dynamic load rating, C	35,000 kN
Basic static load rating, Co	23,200 kN