

## TFE30 INA

Ball bearing units

TYPE: Housing units, Four-bolt flanged housing units, Cast iron housing, Radial insert ball bearing with eccentric locking collar, Centring spigot, type TFE (INA)

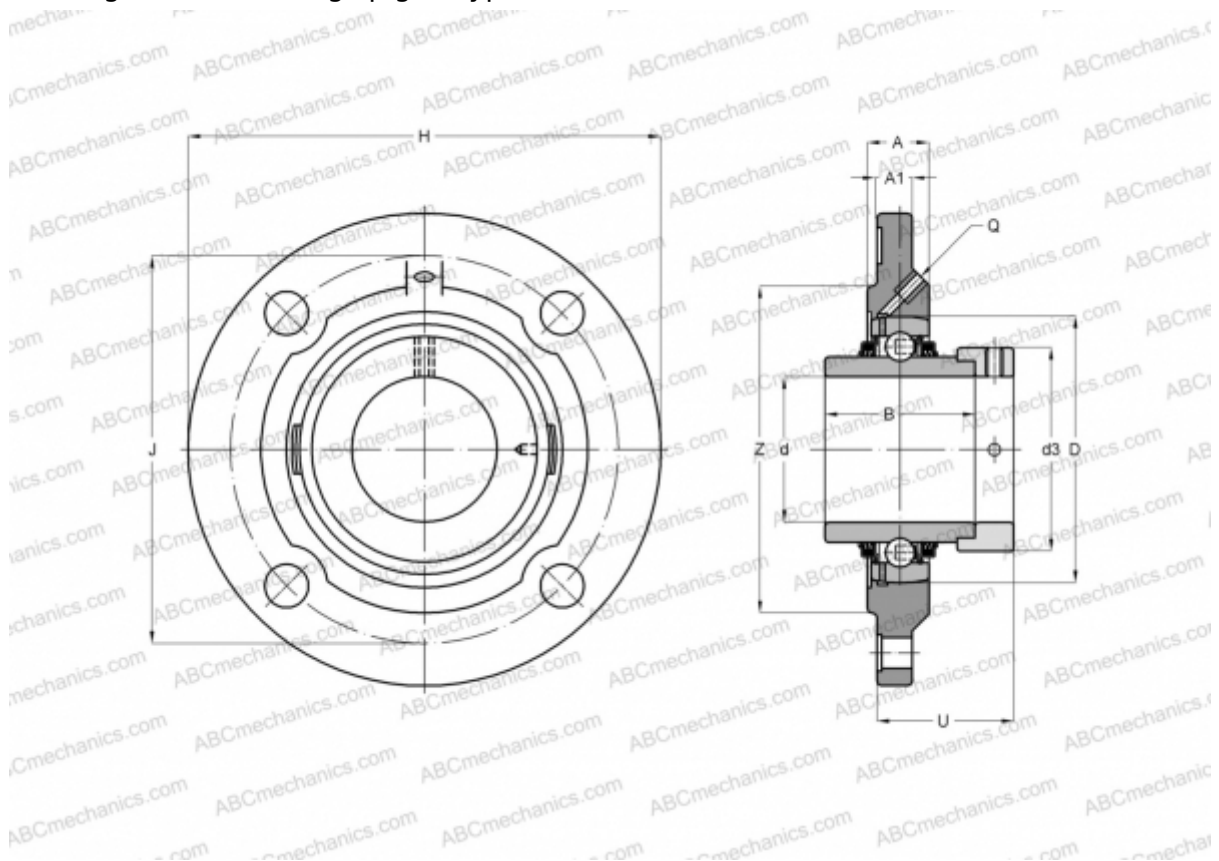

### Technical specification

#### DIMENSIONS, MM

d	30,000
D	62,000
B	48,500
H	127,000
A	22,500
J	105,000
A1	9,500
N	9,000
d3	44,000
U	40,600
Z	85,000
Q	Rp1/8

**WEIGHT, KG** 1,080

Bearing	GE30-KTT-B
Housing	GG.FE06

#### MANUFACTURER

[INA](#)

#### CALCULATION DATA

Basic dynamic load rating, C	19,500 kN
Basic static load rating, Co	11,300 kN