

## PCJY25-N INA

Ball bearing units

TYPE: Housing units, Four-bolt flanged housing units, Cast iron housing, Radial insert ball bearing with grub screws in inner ring, Type PCJY (INA)

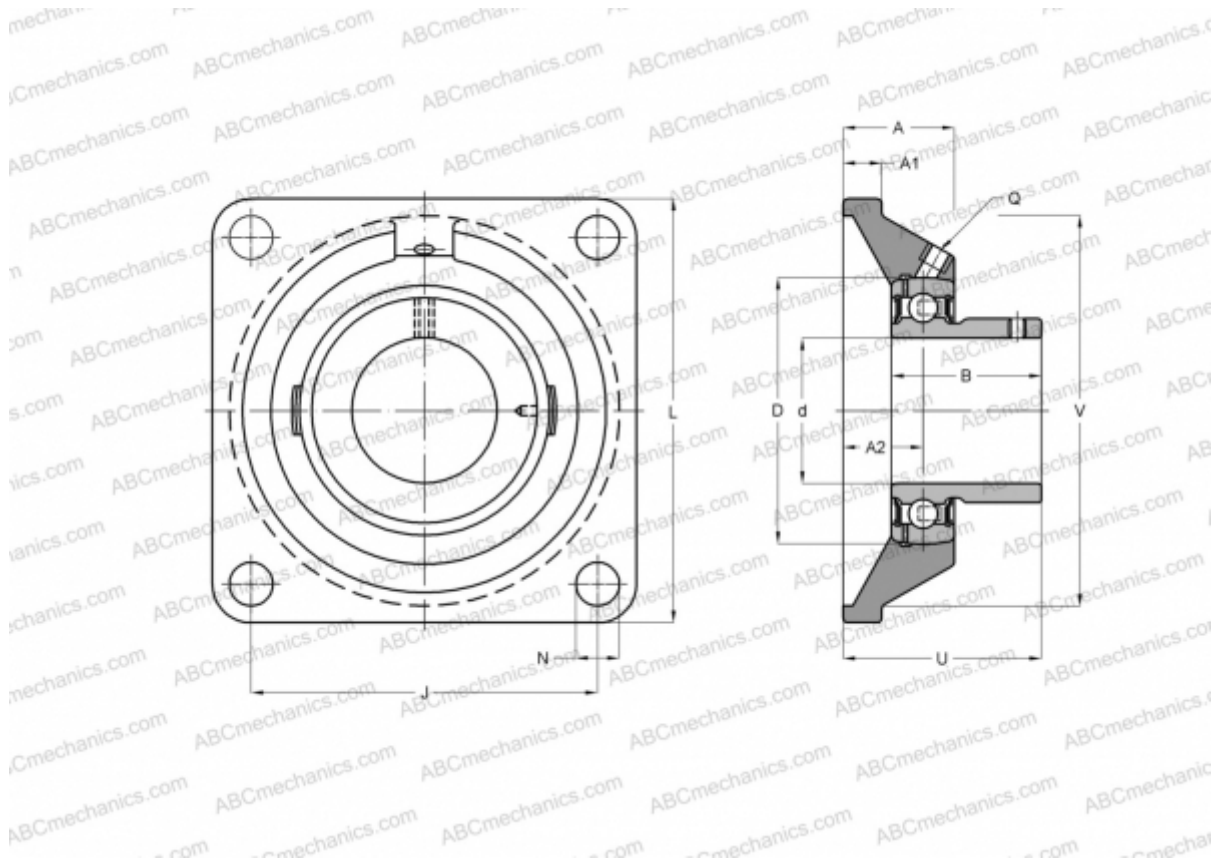

### Technical specification

#### DIMENSIONS, MM

d	25,000
D	52,000
B	27,000
L	95,000
A	29,000
J	70,000
A1	11,000
A2	19,000
N	11,500
U	38,500
V	74,000
Q	Rp1/8

**WEIGHT, KG** 0,720

Bearing	GAY25-NPP-B
Housing	GG.CJ05-N

#### MANUFACTURER

[INA](#)

#### CALCULATION DATA

Basic dynamic load rating, C	14,000 kN
Basic static load rating, Co	7,800 kN