

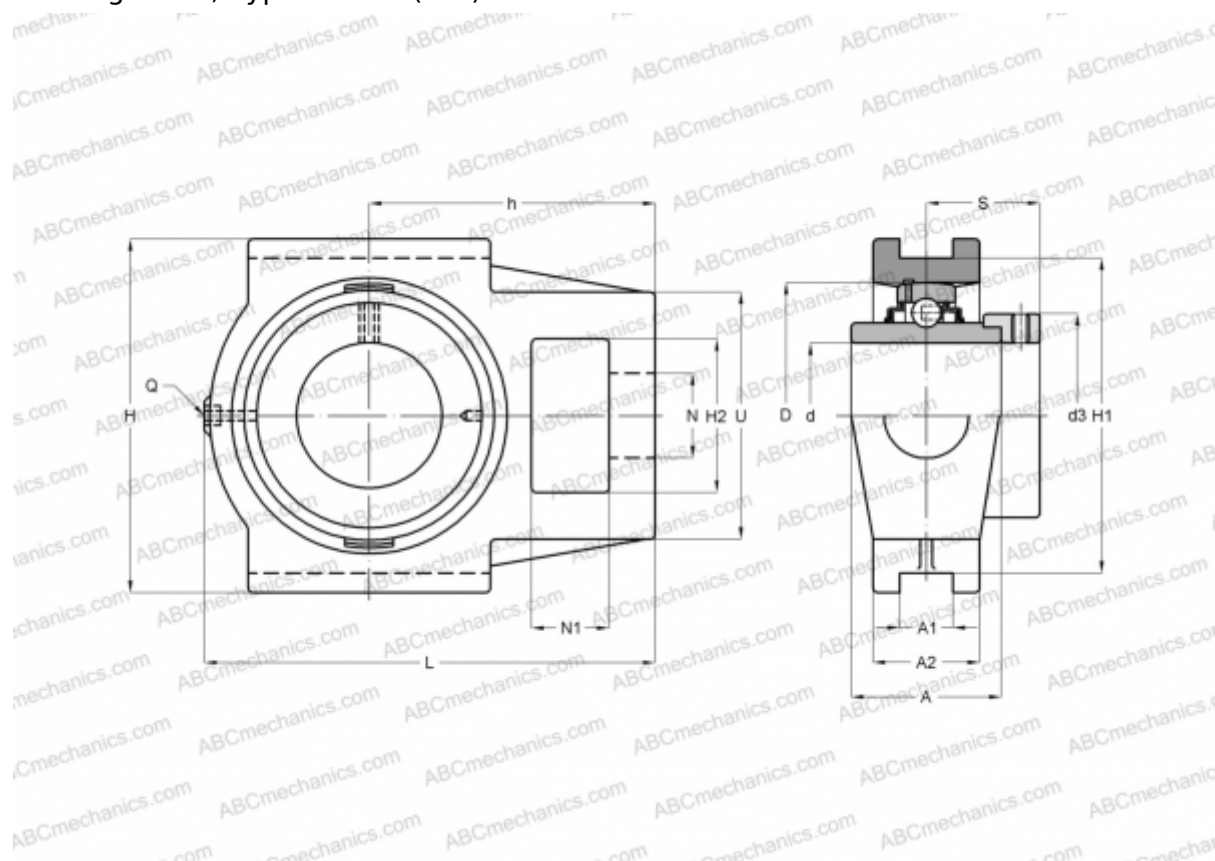

RTUEO80 INA

Ball bearing units

TYPE: Housing units, Take-up housing units, Cast iron housing, Radial insert ball bearing with eccentric locking collar, Type RTUEO (INA)



Technical specification

DIMENSIONS, MM

d	80,000
D	170,000
B	93,700
L	282,000
H	230,000
A	102,000
H2	98,000
A1	30,000
A2	60,000
H1	204,000
N	53,000
N1	42,000
S	59,700
d3	118,000
U	150,000

DIMENSIONS, MM

h	174,000
Q	Rp1/8

WEIGHT, KG

Bearing	GNE80-KRR-B
Housing	GG.TUEO16

MANUFACTURER

[INA](#)

CALCULATION DATA

Basic dynamic load rating, C	123,000 kN
Basic static load rating, Co	87,000 kN