

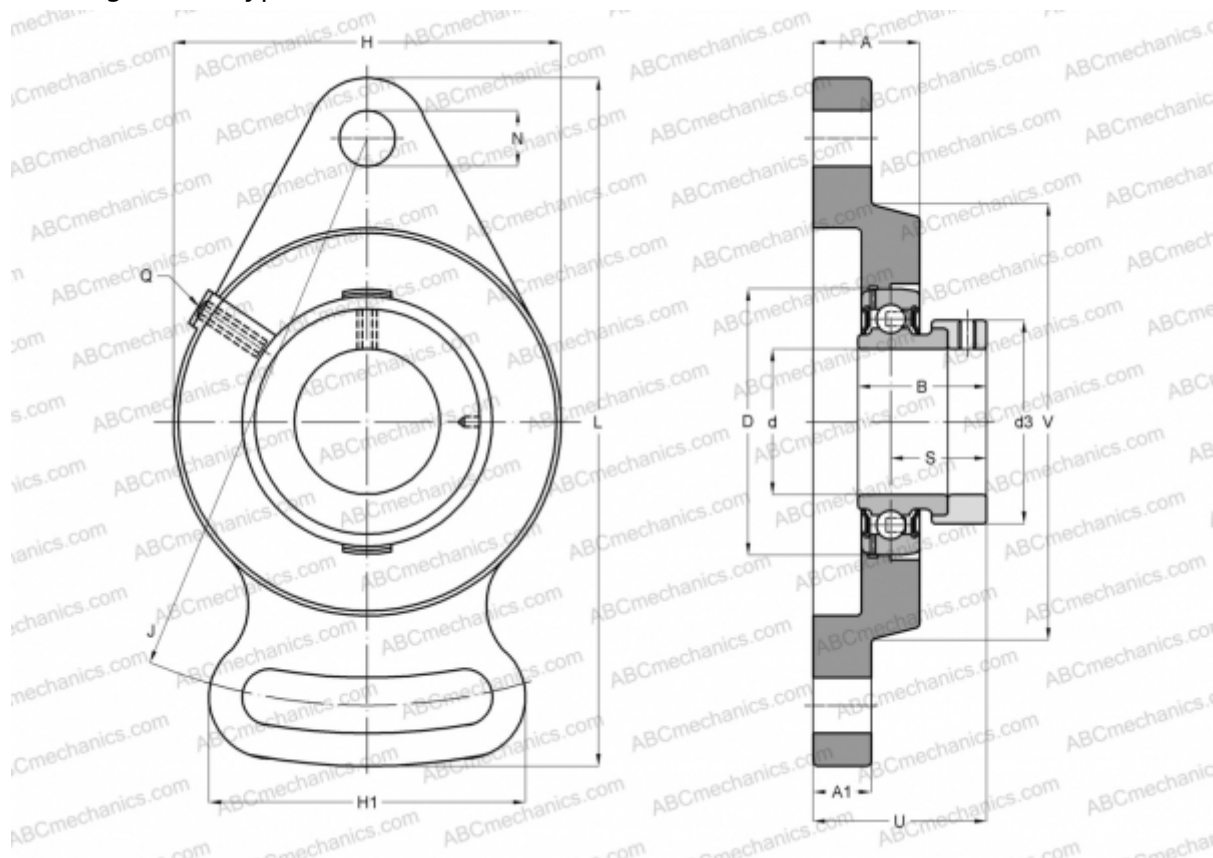

PSFT25 INA

Ball bearing units

TYPE: Housing units, Take-up housing units, Cast iron housing, Radial insert ball bearing with eccentric locking collar, Type PSFT (INA)



Technical specification

DIMENSIONS, MM

d	25,000
D	52,000
B	31,000
L	124,000
H	70,000
A	20,000
J	99,000
A1	11,000
H1	63,000
N	11,500
d3	37,500
U	36,000
Q	Rp1/8

WEIGHT, KG 0,520

Bearing	GRAE25-NPP-B
Housing	GG.SFT05

MANUFACTURER

[INA](#)

CALCULATION DATA

Basic dynamic load rating, C	14,000 kN
Basic static load rating, Co	7,800 kN