

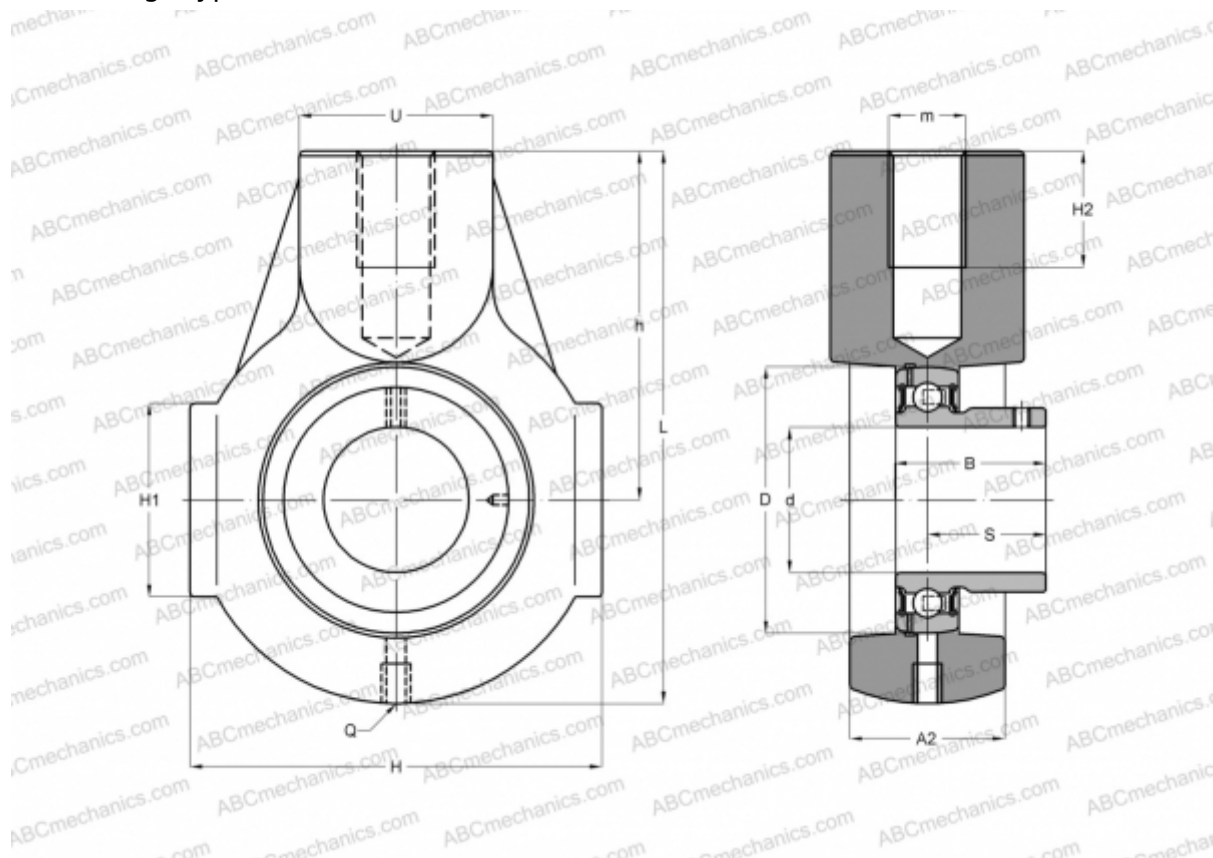

## PHEY35 INA

Ball bearing units

TYPE: Housing units, Take-up housing units, Cast iron housing, Radial insert ball bearing with grub screws in inner ring, Type PHEY (INA)



### Technical specification

#### DIMENSIONS, MM

d	35,000
D	72,000
B	35,000
L	122,000
H	90,000
H2	24,000
A2	32,000
H1	49,000
S	25,500
U	40,000
h	76,000
Q	Rp1/8

**WEIGHT, KG** 1,230

Bearing	GAY35-NPP-B
Housing	GG.HE07

#### MANUFACTURER

[INA](#)

#### CALCULATION DATA

Basic dynamic load rating, C	25,500 kN
Basic static load rating, Co	15,300 kN