

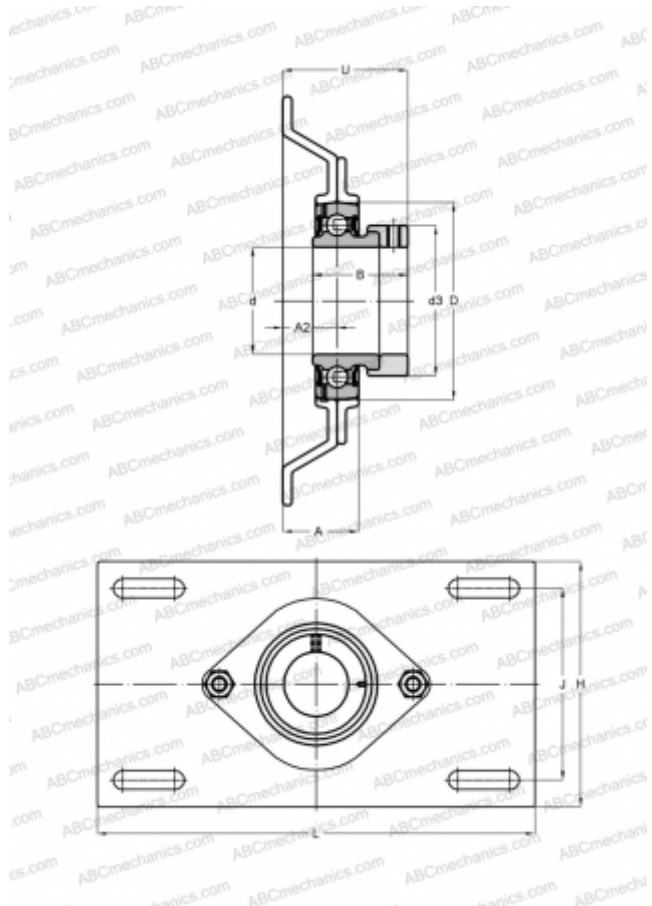

## MSTU25 INA

Ball bearing units

TYPE: Housing units, Take-up housing units, Sheet steel housing, Radial insert ball bearing with eccentric locking collar, Without relubrication facility, type MSTU (INA)



### Technical specification

#### DIMENSIONS, MM

d	25,000
D	52,000
B	31,000
L	203,200
H	104,800
A	19,000
J	80,200
A2	10,300
d3	37,500
U	33,800

#### WEIGHT, KG

0,580

Bearing	RAE25-NPP-B
Housing	GEH52-MSTU

#### MANUFACTURER

[INA](#)

#### CALCULATION DATA

Basic dynamic load rating, C	14,000 kN
Basic static load rating, Co	7,800 kN