

## PHUSE30 INA

Ball bearing units

TYPE: Housing units, Take-up housing units, Cast iron and sheet steel housing, Radial insert ball bearing with eccentric locking collar, Type PHUSE (INA)

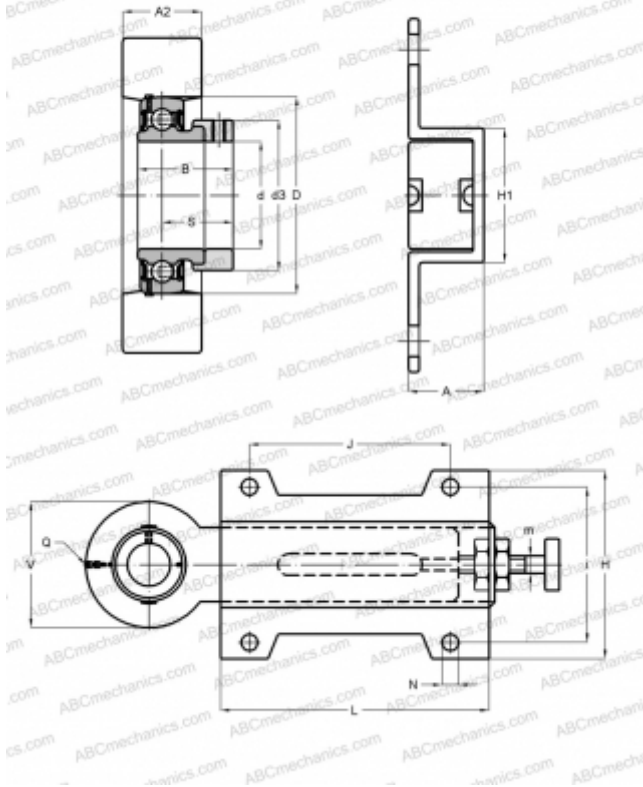

### Technical specification

#### DIMENSIONS, MM

d	30,000
D	62,000
B	35,800
L	187,000
H	103,000
A	28,000
J	140,000
A2	22,000
H1	52,000
N	11,500
S	26,700
d3	44,000
V	88,000
I	80,000
Q	Rp1/8

#### WEIGHT, KG

Bearing	GRAE30-NPP-B
Housing	HUE06 / HUSE07

#### MANUFACTURER

[INA](#)

#### CALCULATION DATA

Basic dynamic load rating, C	19,500 kN
Basic static load rating, Co	11,300 kN