

ESPAE203 SNR

Ball bearing units

TYPE: Housing units, Plummer block, Narrow cast iron housing, Radial insert ball bearing with eccentric locking collar, With inner ring extended at one side

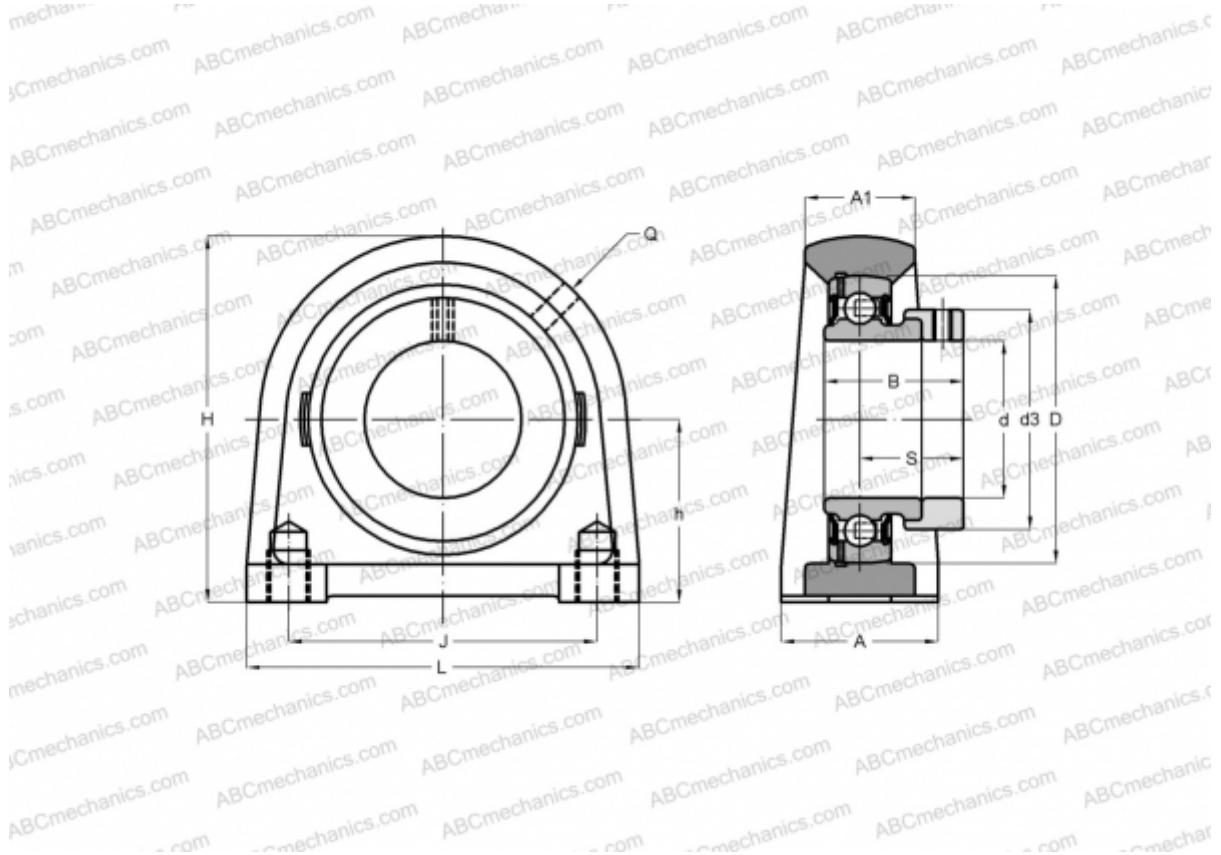

Technical specification

DIMENSIONS, MM

d	17,000
D	40,000
B	28,600
L	63,000
H	57,000
A	30,000
J	47,000
A1	18,000
H1	9,000
S	22,100
d3	28,600
h	30,200
Q	M6x1

WEIGHT, KG 0,400

Bearing	ES203
Housing	PAE203

MANUFACTURER

[SNR](#)

INTERCHANGE

ABC	ESPAE203
INA	PSHE17

CALCULATION DATA

Basic dynamic load rating, C	9,550 kN
Basic static load rating, Co	4,780 kN
Operating temperature min	-20 °C
Operating temperature max	110 °C