

## ESPG201 SNR

Ball bearing units

TYPE: Housing units, Plummer block, Narrow cast iron housing, Radial insert ball bearing with eccentric locking collar, With inner ring extended at one side, wide base

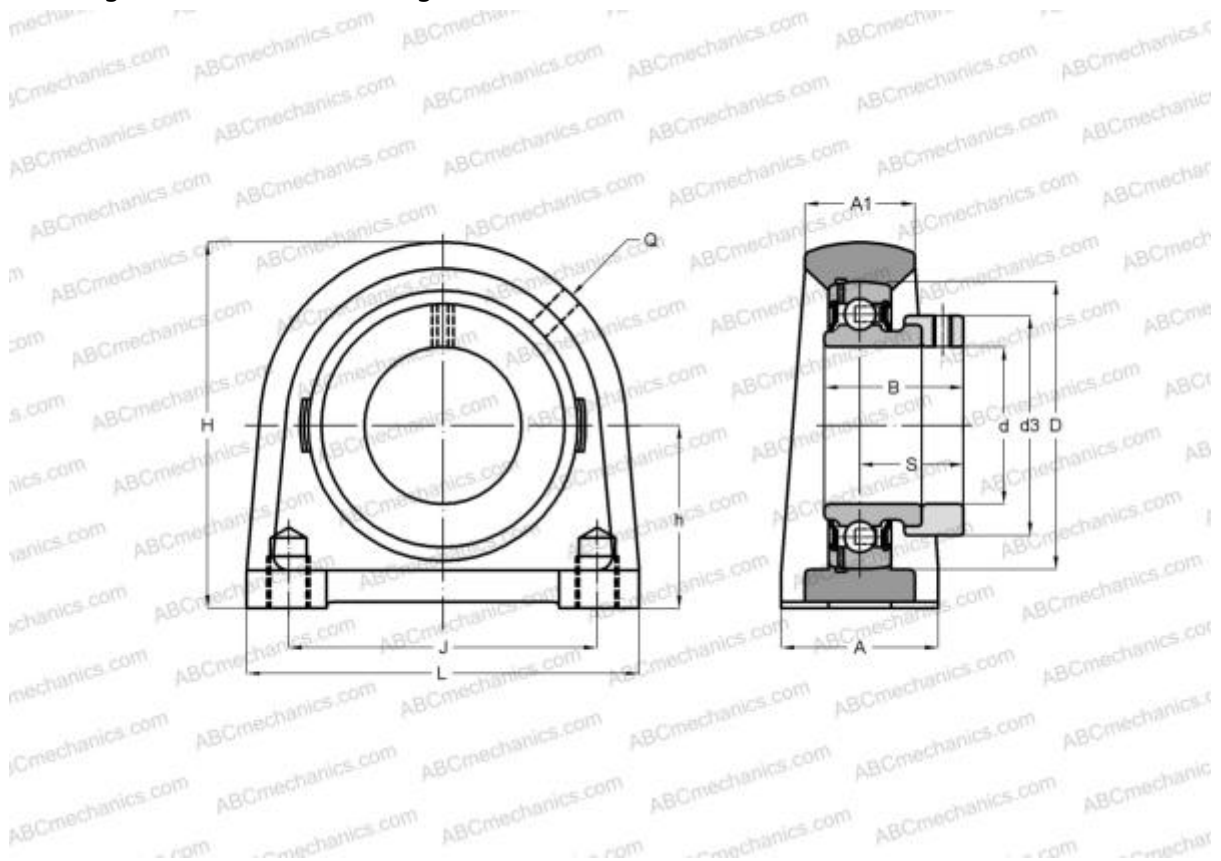

### Technical specification

#### DIMENSIONS, MM

|    |        |
|----|--------|
| d  | 12,000 |
| D  | 47,000 |
| B  | 28,600 |
| L  | 55,000 |
| H  | 57,000 |
| A  | 30,000 |
| J  | 38,000 |
| A1 | 13,000 |
| H1 | 14,000 |
| S  | 22,100 |
| d3 | 28,600 |
| h  | 30,200 |
| Q  | M6x1   |

|         |       |
|---------|-------|
| Bearing | ES201 |
| Housing | PG203 |

#### MANUFACTURER

[SNR](#)

#### INTERCHANGE

ABC [ESPG201](#)

#### CALCULATION DATA

|                              |          |
|------------------------------|----------|
| Basic dynamic load rating, C | 9,550 kN |
| Basic static load rating, Co | 4,780 kN |
| Operating temperature min    | -20 °C   |
| Operating temperature max    | 110 °C   |

**WEIGHT, KG** 0,400