

## ESPG202 ABC

Ball bearing units

TYPE: Housing units, Plummer block, Narrow cast iron housing, Radial insert ball bearing with eccentric locking collar, With inner ring extended at one side, wide base

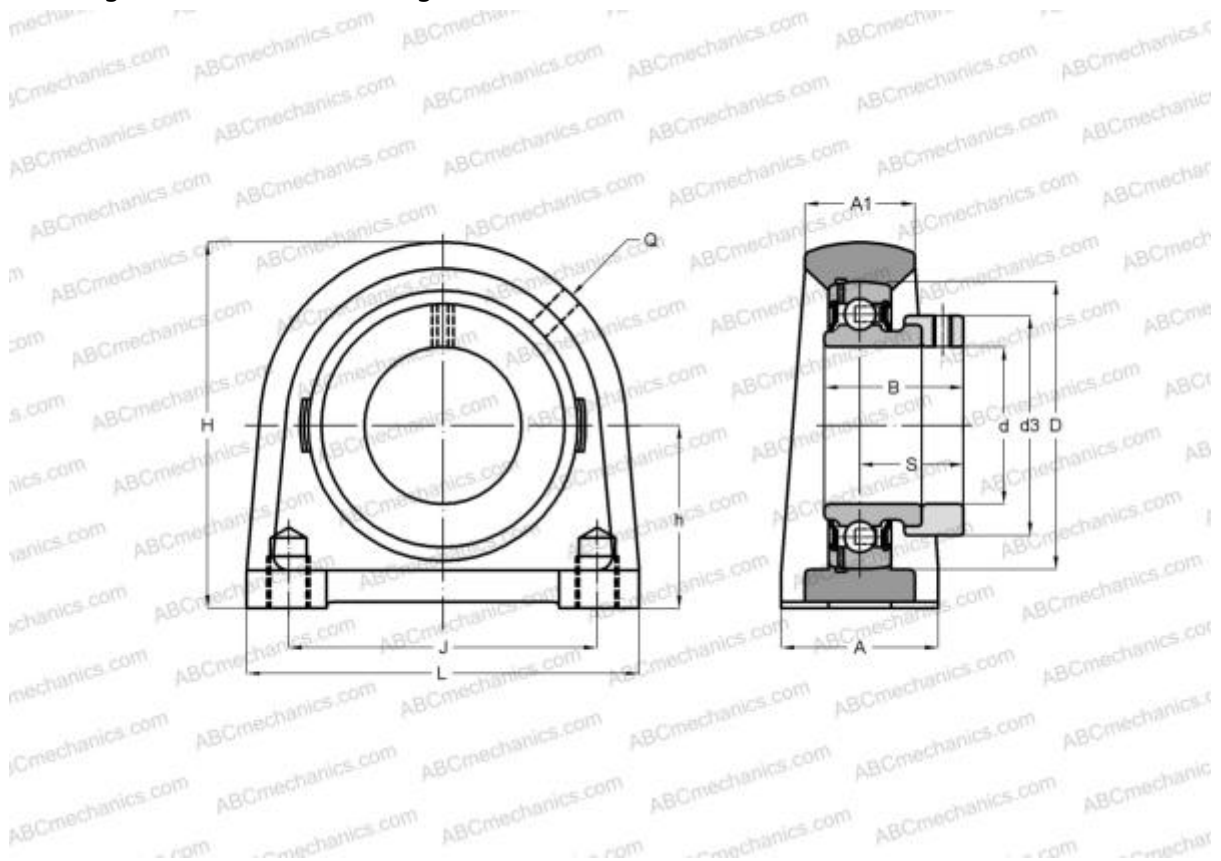

### Technical specification

#### DIMENSIONS, MM

d	15,000
D	47,000
B	28,600
L	55,000
H	57,000
A	30,000
J	38,000
A1	13,000
H1	14,000
S	22,100
d3	28,600
h	30,200
Q	M6x1

Bearing	ES202
Housing	PG203

#### MANUFACTURER

[ABC](#)

#### INTERCHANGE

SNR	<a href="#">ESPG202</a>
-----	-------------------------

#### WEIGHT, KG

0,400