

ESPG202 SNR

Ball bearing units

TYPE: Housing units, Plummer block, Narrow cast iron housing, Radial insert ball bearing with eccentric locking collar, With inner ring extended at one side, wide base

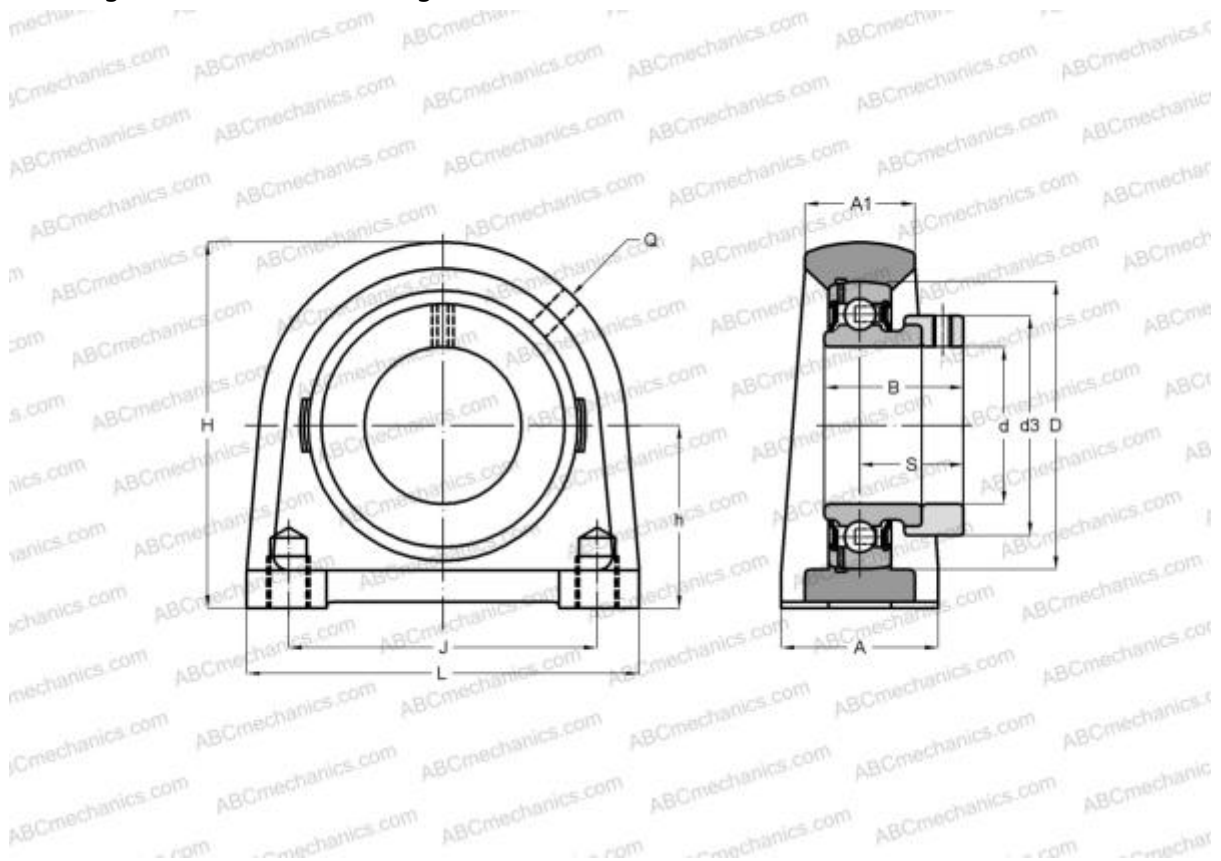

Technical specification

DIMENSIONS, MM

d	15,000
D	47,000
B	28,600
L	55,000
H	57,000
A	30,000
J	38,000
A1	13,000
H1	14,000
S	22,100
d3	28,600
h	30,200
Q	M6x1

Bearing	ES202
Housing	PG203

MANUFACTURER

[SNR](#)

INTERCHANGE

ABC	ESPG202
-----	-------------------------

CALCULATION DATA

Basic dynamic load rating, C	9,550 kN
Basic static load rating, Co	4,780 kN
Operating temperature min	-20 °C
Operating temperature max	110 °C

WEIGHT, KG	0,400
------------	-------