

ESPG204 ABC

Ball bearing units

TYPE: Housing units, Plummer block, Narrow cast iron housing, Radial insert ball bearing with eccentric locking collar, With inner ring extended at one side, wide base

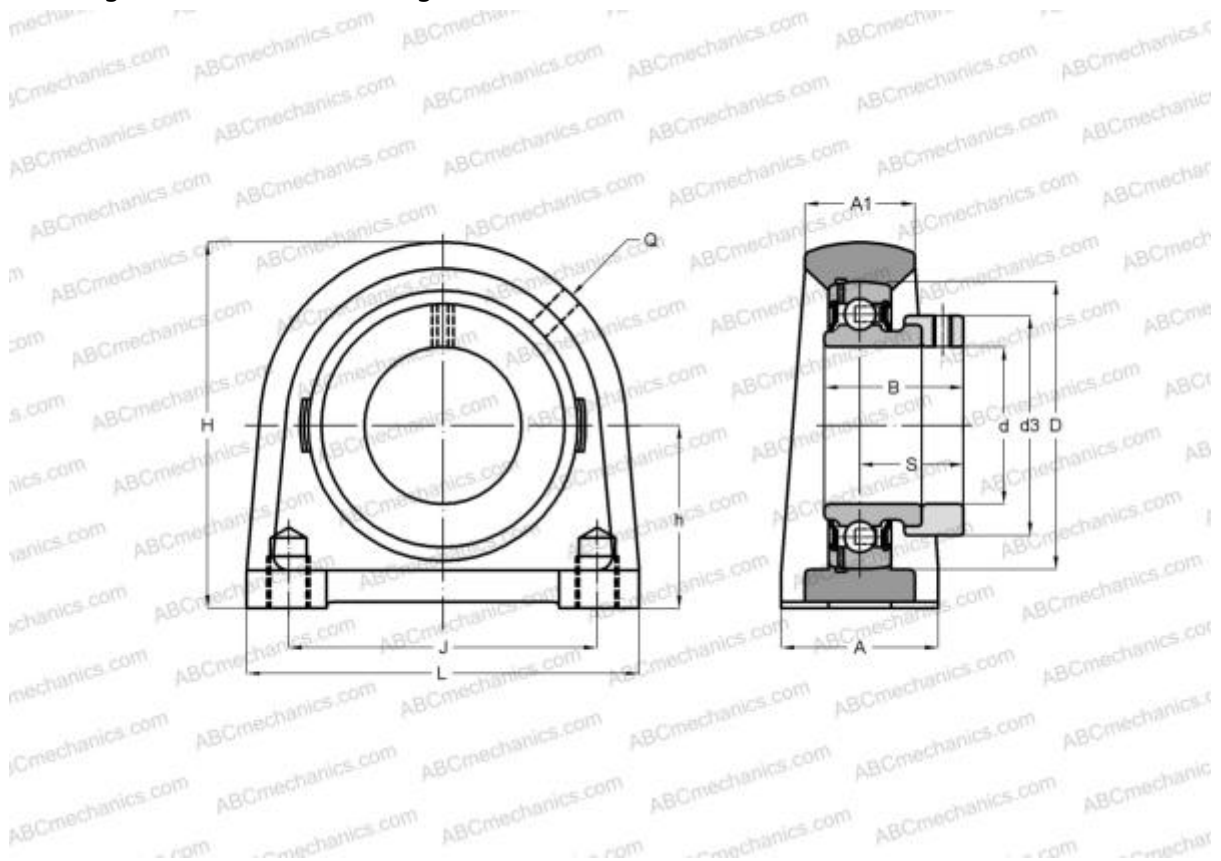

Technical specification

DIMENSIONS, MM

d	20,000
D	47,000
B	30,900
L	70,000
H	64,000
A	38,000
J	49,000
A1	20,000
H1	14,000
S	23,400
d3	33,300
h	33,300
Q	M6x1

Bearing	ES204
Housing	PG204

MANUFACTURER

[ABC](#)

INTERCHANGE

SNR	ESPG204
-----	-------------------------

WEIGHT, KG

0,600