

## ESPG204 SNR

Ball bearing units

TYPE: Housing units, Plummer block, Narrow cast iron housing, Radial insert ball bearing with eccentric locking collar, With inner ring extended at one side, wide base

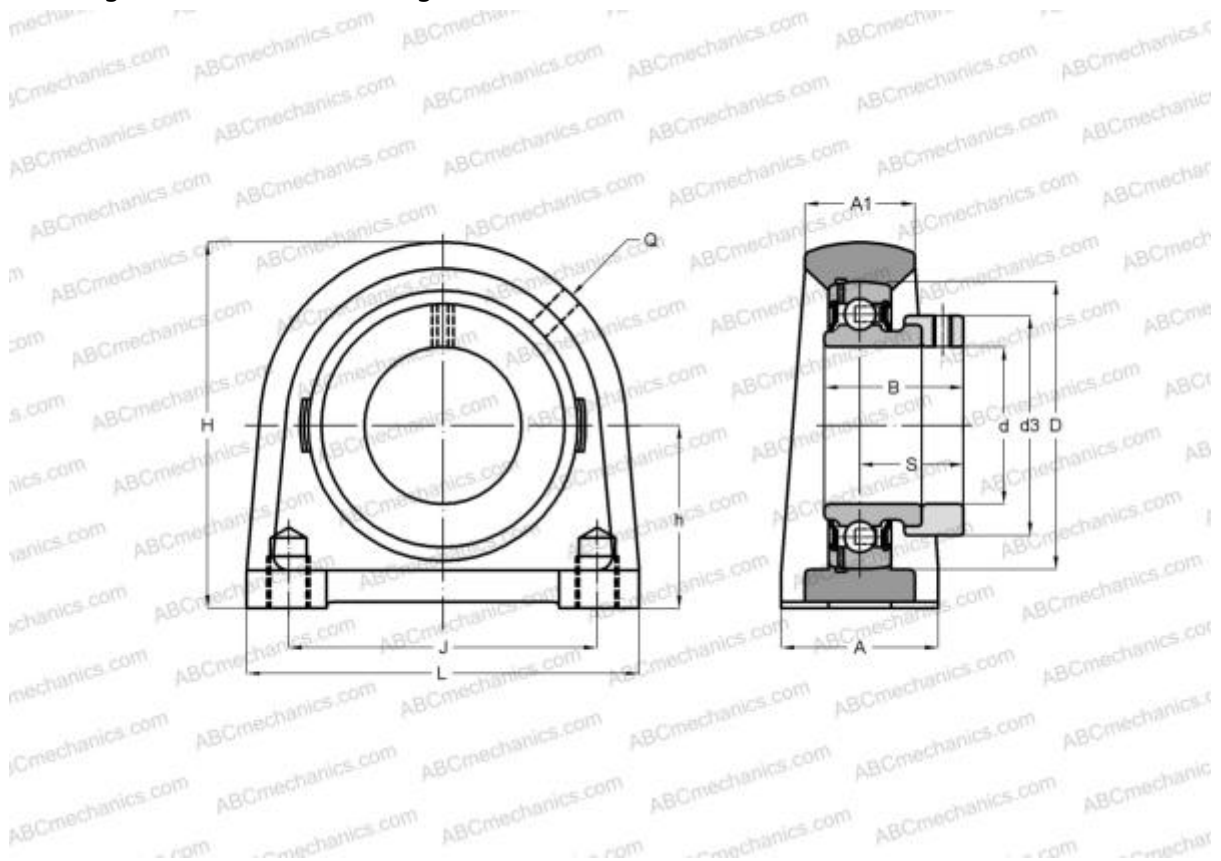

### Technical specification

#### DIMENSIONS, MM

d	20,000
D	47,000
B	30,900
L	70,000
H	64,000
A	38,000
J	49,000
A1	20,000
H1	14,000
S	23,400
d3	33,300
h	33,300
Q	M6x1

Bearing	ES204
Housing	PG204

#### MANUFACTURER

[SNR](#)

#### INTERCHANGE

ABC	<a href="#">ESPG204</a>
-----	-------------------------

#### CALCULATION DATA

Basic dynamic load rating, C	12,800 kN
Basic static load rating, Co	6,650 kN
Operating temperature min	-20 °C
Operating temperature max	110 °C

<b>WEIGHT, KG</b>	0,600
-------------------	-------