

ESPG205 ABC

Ball bearing units

TYPE: Housing units, Plummer block, Narrow cast iron housing, Radial insert ball bearing with eccentric locking collar, With inner ring extended at one side, wide base

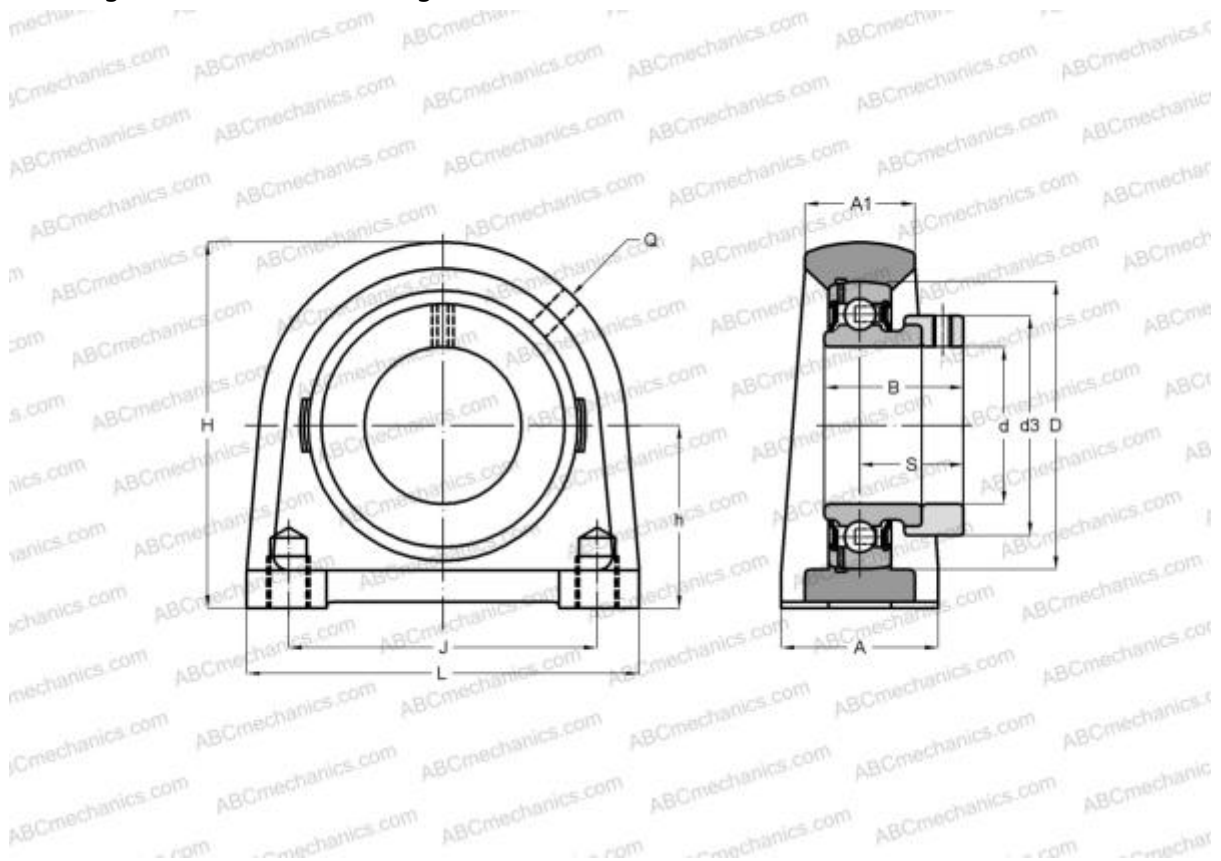

Technical specification

DIMENSIONS, MM

d	25,000
D	52,000
B	30,900
L	75,000
H	70,000
A	38,000
J	50,000
A1	25,000
H1	15,000
S	23,400
d3	38,100
h	36,500
Q	M6x1

Bearing	ES205
Housing	PG205

MANUFACTURER

[ABC](#)

INTERCHANGE

SNR	ESPG205
-----	-------------------------

WEIGHT, KG

0,700