

ESPG205 SNR

Ball bearing units

TYPE: Housing units, Plummer block, Narrow cast iron housing, Radial insert ball bearing with eccentric locking collar, With inner ring extended at one side, wide base

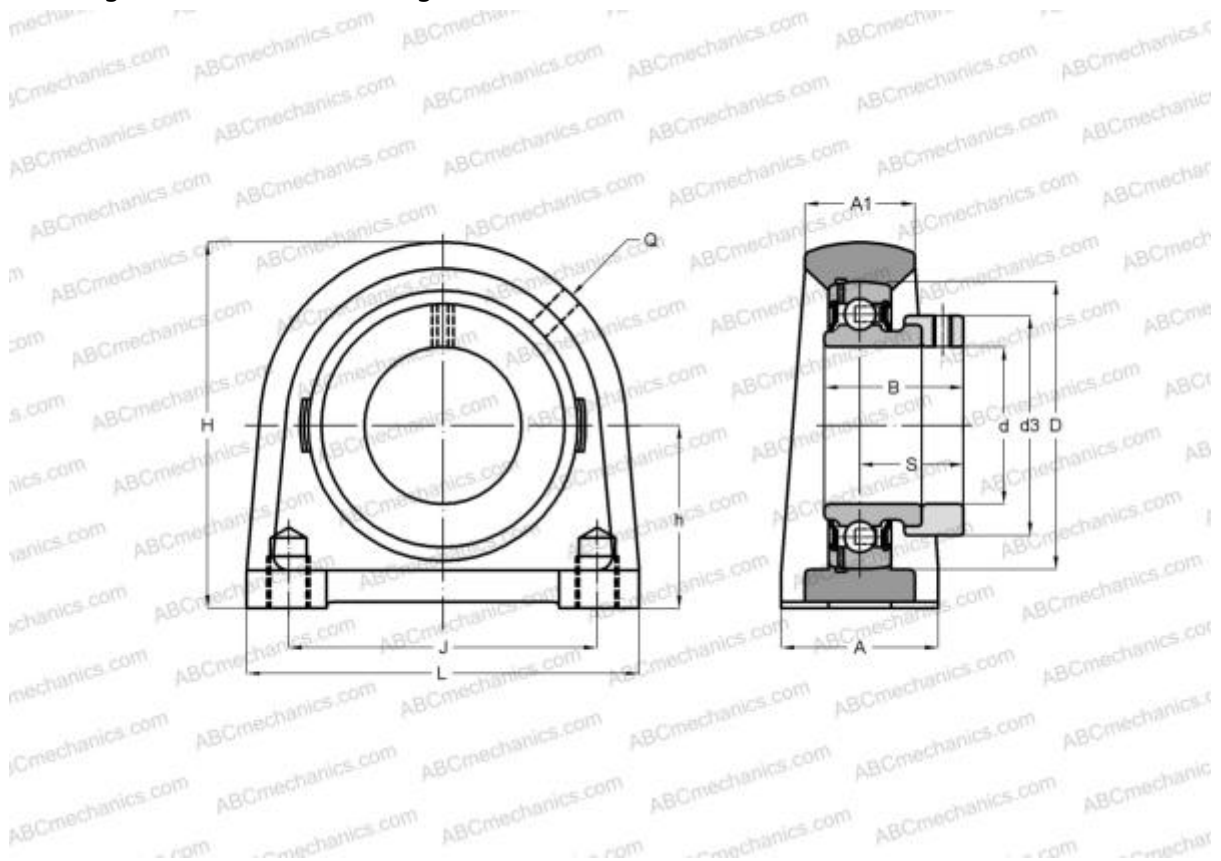

Technical specification

DIMENSIONS, MM

d	25,000
D	52,000
B	30,900
L	75,000
H	70,000
A	38,000
J	50,000
A1	25,000
H1	15,000
S	23,400
d3	38,100
h	36,500
Q	M6x1

Bearing	ES205
Housing	PG205

MANUFACTURER

[SNR](#)

INTERCHANGE

ABC	ESPG205
-----	-------------------------

CALCULATION DATA

Basic dynamic load rating, C	14,000 kN
Basic static load rating, Co	7,880 kN
Operating temperature min	-20 °C
Operating temperature max	110 °C

WEIGHT, KG	0,700
-------------------	-------