

ESPA201 SNR

Ball bearing units

TYPE: Housing units, Plummer block, Narrow cast iron housing, Radial insert ball bearing with eccentric locking collar, With inner ring extended at one side, wide base, massive bearing units

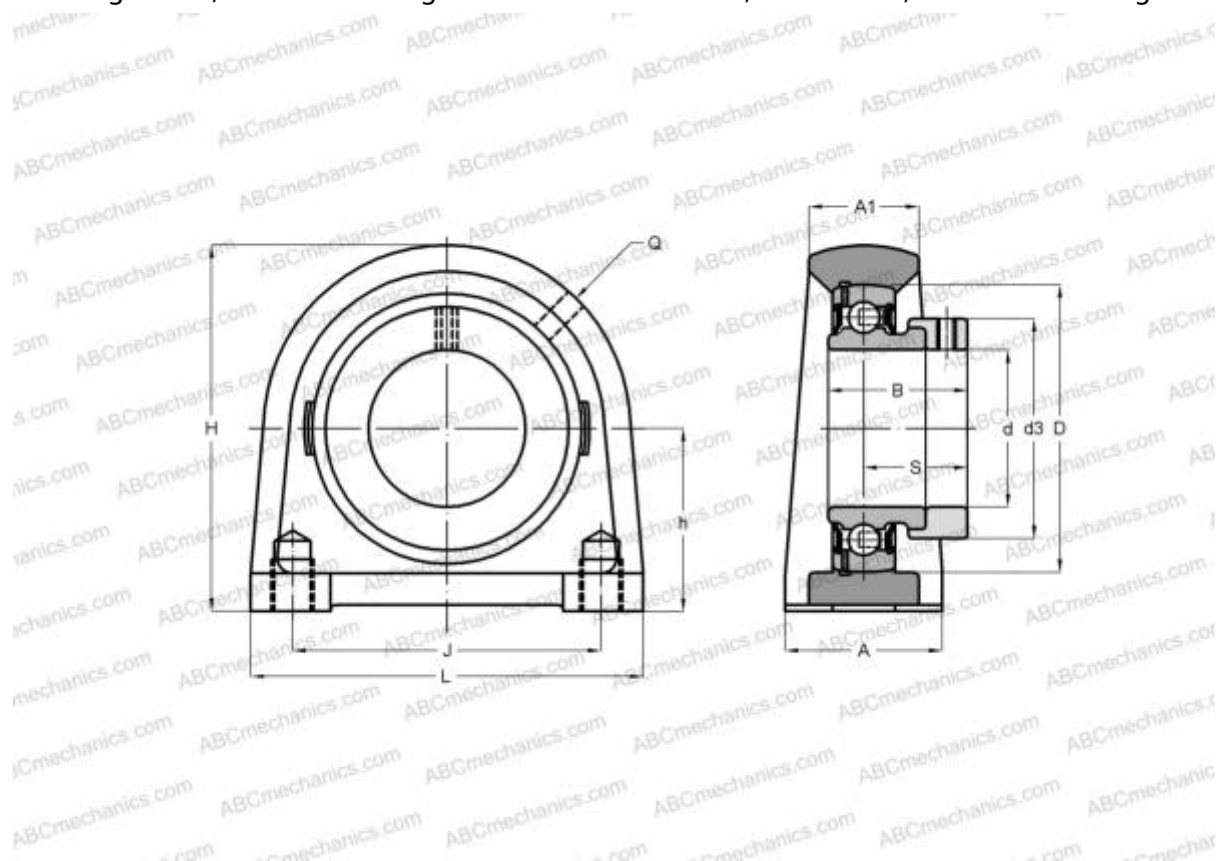

Technical specification

DIMENSIONS, MM

d	12,000
D	40,000
B	28,600
L	70,000
H	57,000
A	36,000
J	48,000
A1	19,000
H1	10,000
S	22,100
d3	28,600
h	30,200
Q	M6x1

Bearing	ES201
Housing	PA203

MANUFACTURER

[SNR](#)

INTERCHANGE

ABC	ESPA201
-----	-------------------------

CALCULATION DATA

Basic dynamic load rating, C	9,550 kN
Basic static load rating, Co	4,780 kN
Operating temperature min	-20 °C
Operating temperature max	110 °C

WEIGHT, KG	0,400
-------------------	-------