

## ESPA203 SNR

Ball bearing units

TYPE: Housing units, Plummer block, Narrow cast iron housing, Radial insert ball bearing with eccentric locking collar, With inner ring extended at one side, wide base, massive bearing units

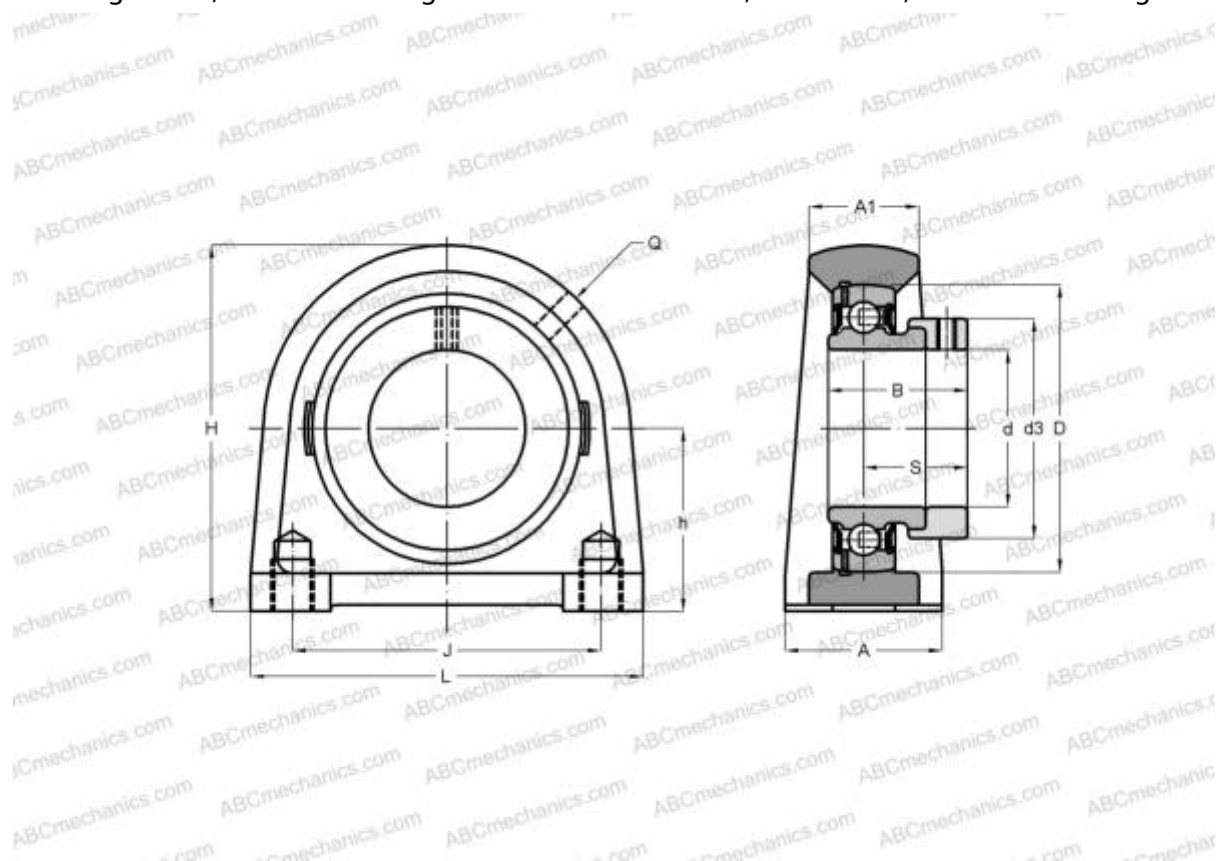

### Technical specification

#### DIMENSIONS, MM

d	17,000
D	40,000
B	28,600
L	70,000
H	57,000
A	36,000
J	48,000
A1	19,000
H1	10,000
S	22,100
d3	28,600
h	30,200
Q	M6x1

Bearing	ES203
Housing	PA203

#### MANUFACTURER

[SNR](#)

#### INTERCHANGE

ABC [ESPA203](#)

#### CALCULATION DATA

Basic dynamic load rating, C	9,550 kN
Basic static load rating, Co	4,780 kN
Operating temperature min	-20 °C
Operating temperature max	110 °C

#### WEIGHT, KG

0,400