

ESPA204 ABC

Ball bearing units

TYPE: Housing units, Plummer block, Narrow cast iron housing, Radial insert ball bearing with eccentric locking collar, With inner ring extended at one side, wide base, massive bearing units

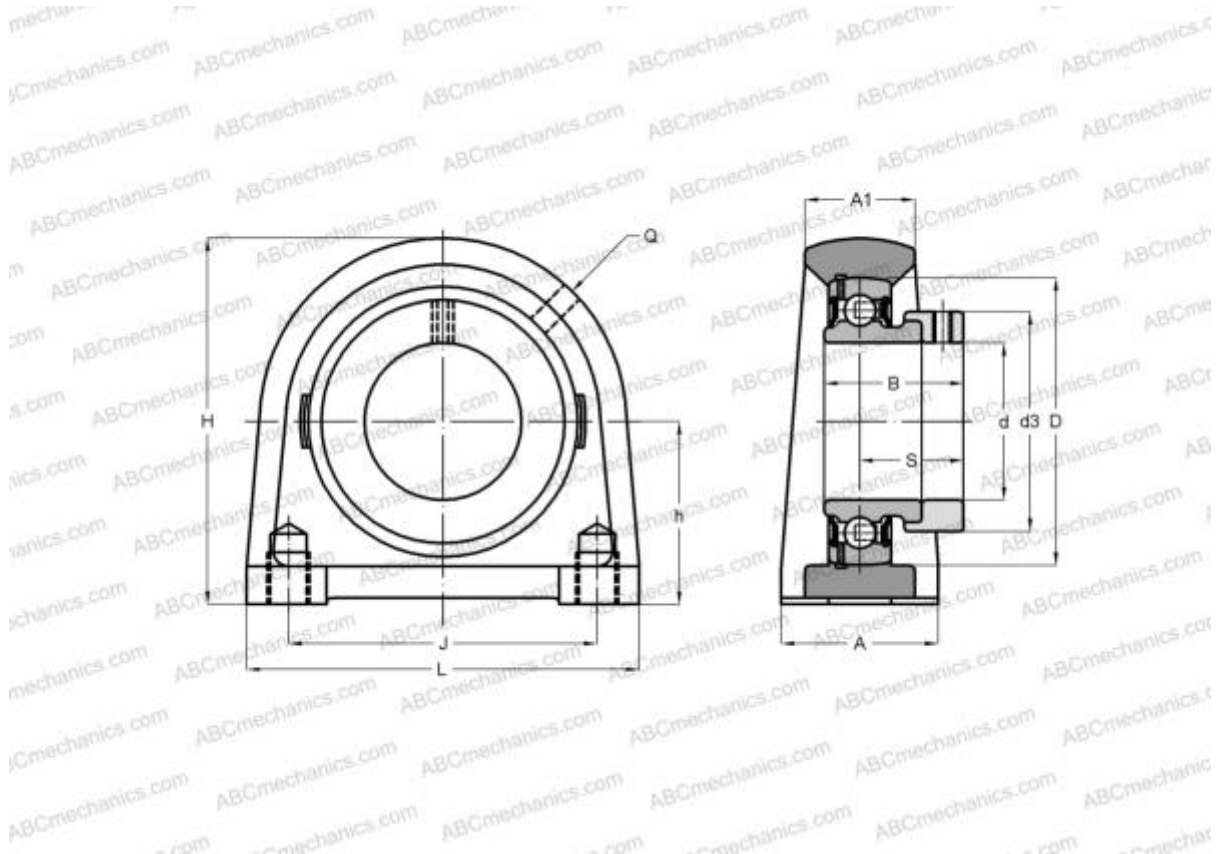

Technical specification

DIMENSIONS, MM

d	20,000
D	47,000
B	30,900
L	76,000
H	62,000
A	40,000
J	52,000
A1	22,000
H1	11,000
S	23,400
d3	33,300
h	30,200
Q	M6x1

WEIGHT, KG 0,500

Bearing	ES204
Housing	PA204

MANUFACTURER [ABC](#)

INTERCHANGE [SNR](#) [ESPA204](#)