

UKFCE206H ABC

Ball bearing units

TYPE: Housing units, Four-bolt flanged housing units, Cast iron housing, Radial insert ball bearing with adapter sleeve, With inner ring extended on both sides, round flanged

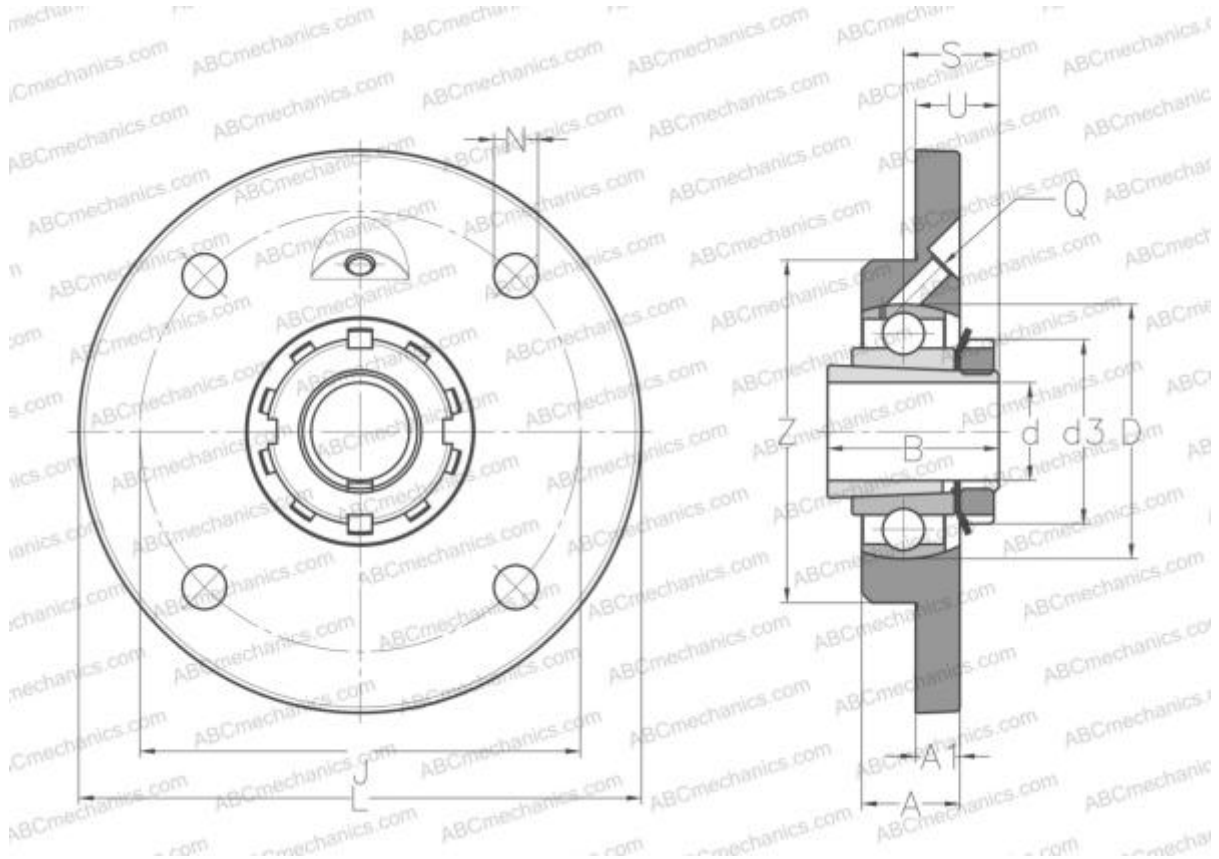

Technical specification

DIMENSIONS, MM

d	25,000
D	62,000
B	38,000
H	125,000
A	21,000
J	100,000
A1	9,500
N	11,500
S	20,500
d3	45,000
U	22,500
Z	80,000
Q	M6x1

WEIGHT, KG 1,000

Bearing	UK206 +
Housing	FCE206
Adapter sleeve	H2306

MANUFACTURER

[ABC](#)

INTERCHANGE

SNR	UKFCE206H
-----	---------------------------