

ESFAE204 SNR

Ball bearing units

TYPE: Housing units, Take-up housing units, Cast iron housing, Radial insert ball bearing with eccentric locking collar, With inner ring extended at one side

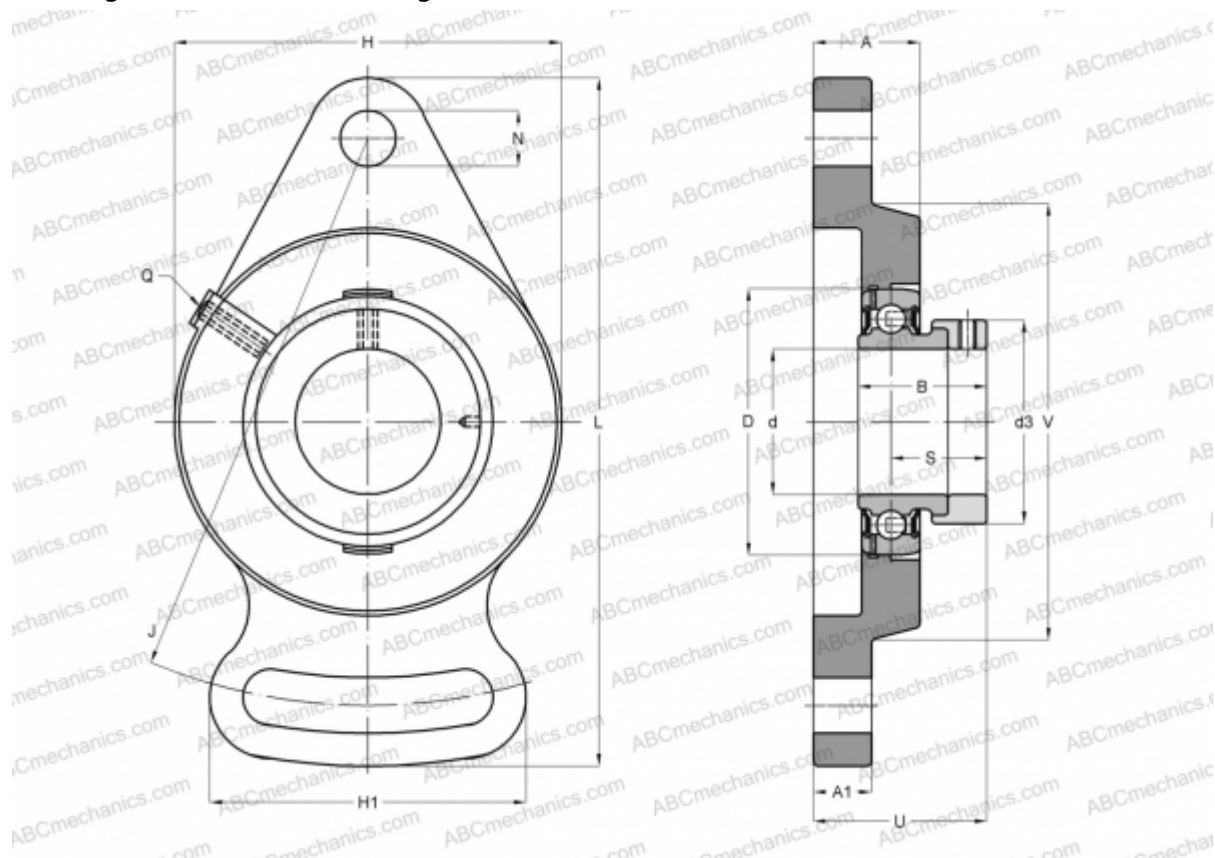

Technical specification

DIMENSIONS, MM

d	20,000
D	47,000
B	30,900
L	112,000
H	61,000
A	20,000
J	90,000
A1	10,000
A2	10,500
H1	52,000
N	11,500
S	7,500
d3	33,300
U	33,900
Z	50,800

DIMENSIONS, MM

Q	R1/8"
---	-------

WEIGHT, KG

Bearing	ES204
Housing	FAE204

MANUFACTURER

[SNR](#)

INTERCHANGE

ABC	ESFAE204
INA	PSFT20

CALCULATION DATA

Basic dynamic load rating, C	12,800 kN
Basic static load rating, Co	6,650 kN
Operating temperature min	-20 °C



CALCULATION DATA

Operating temperature max

110 °C

