

ESFAE205 SNR

Ball bearing units

TYPE: Housing units, Take-up housing units, Cast iron housing, Radial insert ball bearing with eccentric locking collar, With inner ring extended at one side

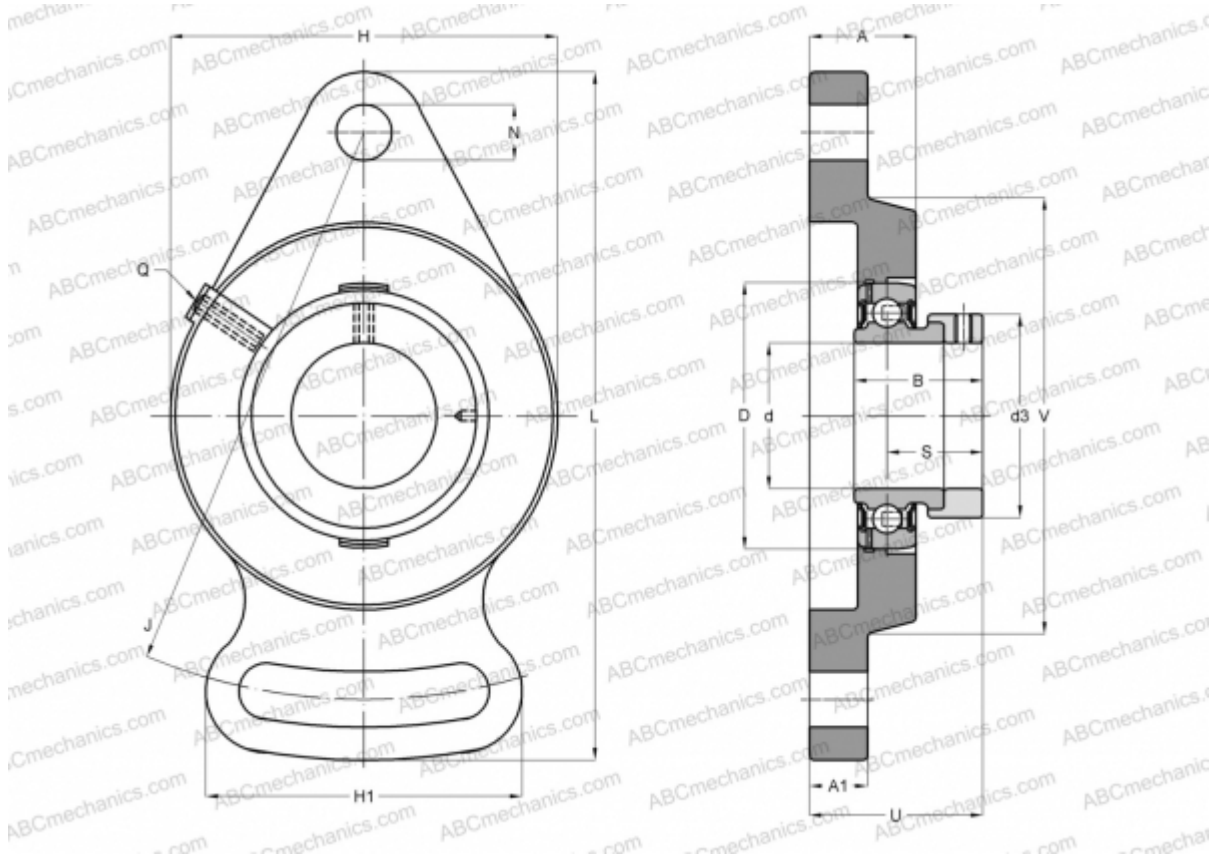

Technical specification

DIMENSIONS, MM

d	25,000
D	52,000
B	30,900
L	124,000
H	70,000
A	22,500
J	99,000
A1	11,000
A2	12,500
H1	63,000
N	11,500
S	7,500
d3	38,100
U	35,900
Z	63,500

DIMENSIONS, MM

Q	R1/8"
---	-------

WEIGHT, KG

Bearing	ES205
Housing	FAE205

MANUFACTURER

[SNR](#)

INTERCHANGE

ABC	ESFAE205
INA	PSFT25

CALCULATION DATA

Basic dynamic load rating, C	14,000 kN
Basic static load rating, Co	7,880 kN
Operating temperature min	-20 °C



CALCULATION DATA

Operating temperature max

110 °C

