

ESFAE206 SNR

Ball bearing units

TYPE: Housing units, Take-up housing units, Cast iron housing, Radial insert ball bearing with eccentric locking collar, With inner ring extended at one side

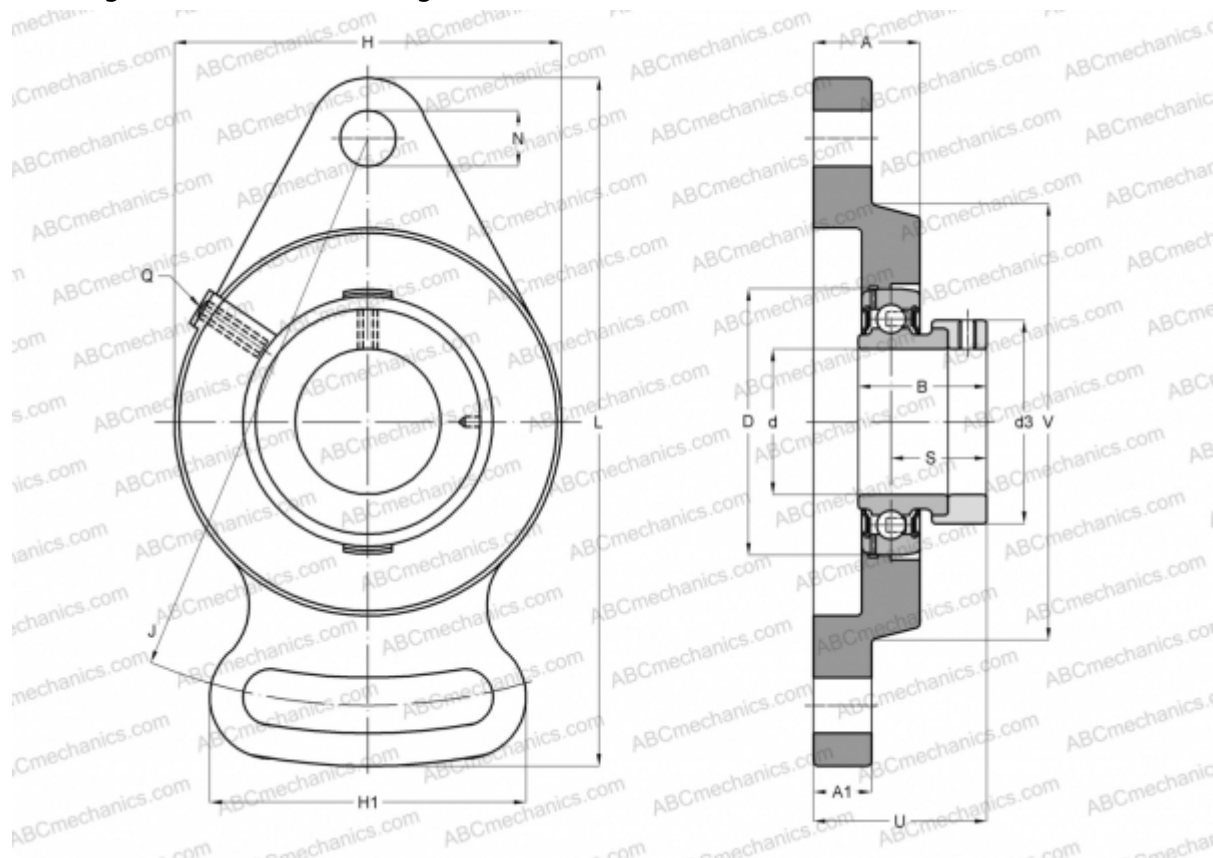

Technical specification

DIMENSIONS, MM

d	30,000
D	62,000
B	35,700
L	142,000
H	80,000
A	24,000
J	117,000
A1	12,000
A2	13,000
H1	65,000
N	11,500
S	9,000
d3	44,500
U	39,700
Z	73,000

DIMENSIONS, MM

Q	R1/8"
---	-------

WEIGHT, KG

Bearing	ES206
Housing	FAE206

MANUFACTURER

[SNR](#)

INTERCHANGE

ABC	ESFAE206
INA	PSFT30

CALCULATION DATA

Basic dynamic load rating, C	19,500 kN
Basic static load rating, Co	11,200 kN
Operating temperature min	-20 °C



CALCULATION DATA

Operating temperature max

110 °C

