

PSFT35 INA

Ball bearing units

TYPE: Housing units, Take-up housing units, Cast iron housing, Radial insert ball bearing with eccentric locking collar, With inner ring extended at one side

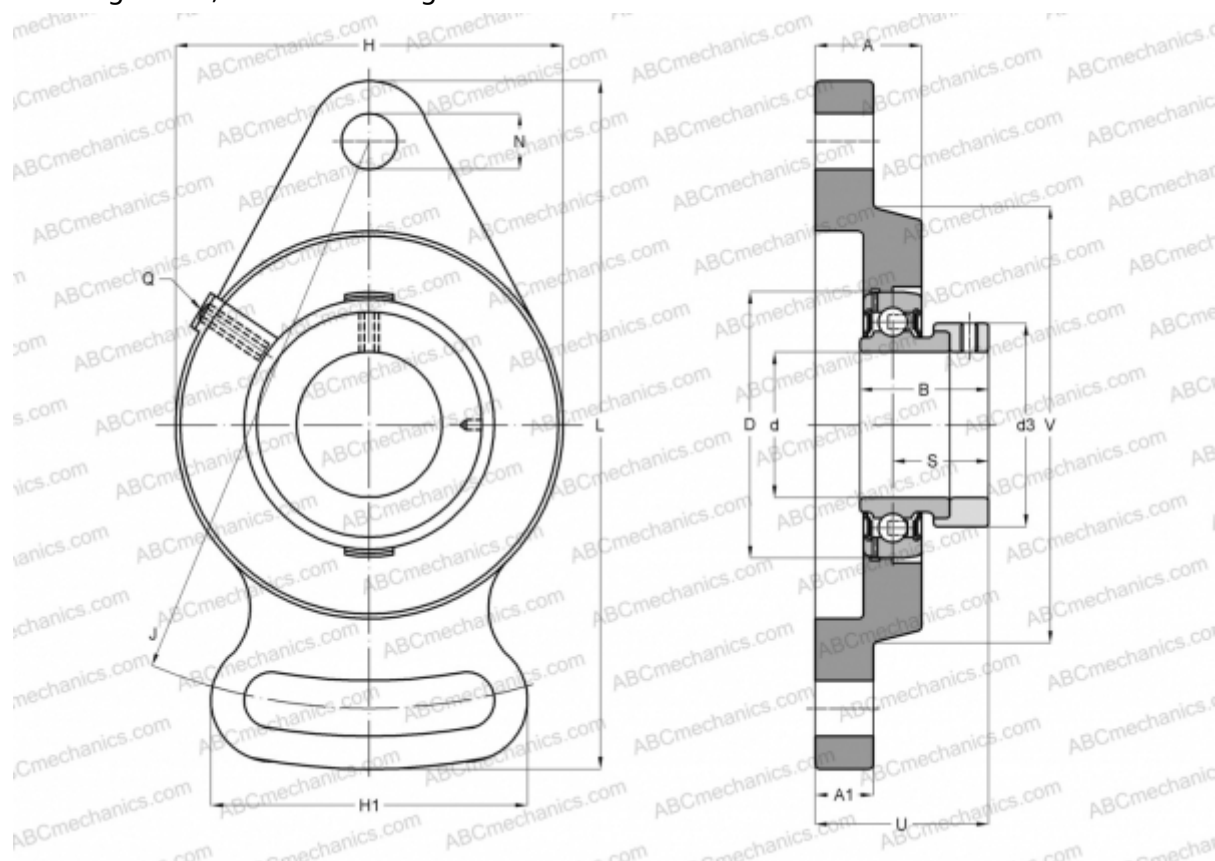

Technical specification

DIMENSIONS, MM

d	35,000
D	72,000
B	39,000
L	155,000
H	90,000
A	25,000
J	128,000
A1	12,500
H1	75,000
N	14,000
d3	51,000
U	44,500
Q	Rp1/8

Bearing	GRAE35-NPP-B
Housing	GG.SFT07

MANUFACTURER

[INA](#)

INTERCHANGE

ABC	ESFAE207
SNR	ESFAE207

CALCULATION DATA

Basic dynamic load rating, C	25,500 kN
Basic static load rating, Co	15,300 kN

WEIGHT, KG 1,100