

## ESC203 SNR

Ball bearing units

TYPE: Housing units, Cartridge units, Cast iron housing, Radial insert ball bearing with eccentric locking collar, With inner ring extended at one side

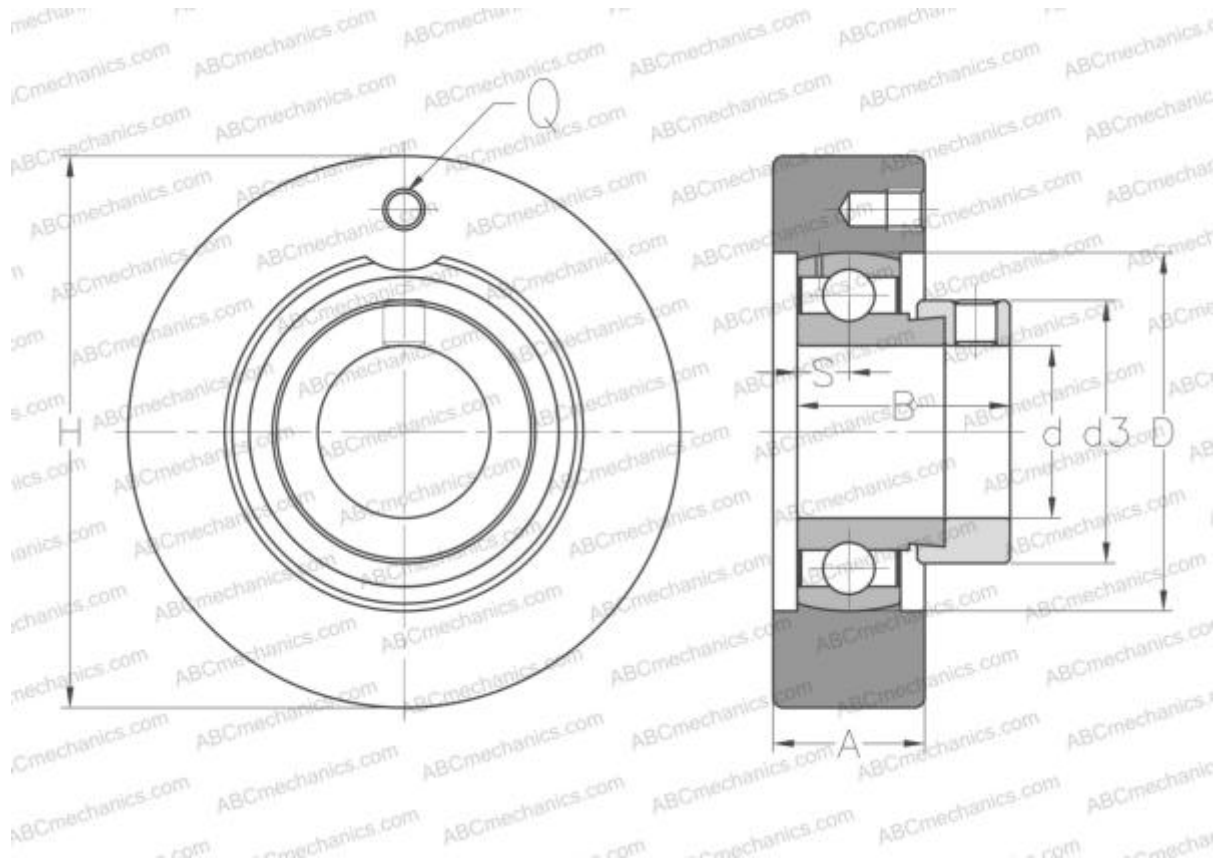

### Technical specification

#### DIMENSIONS, MM

d	17,000
D	40,000
B	28,600
H	67,000
A	20,000
S	6,500
d3	28,600
Q	M6x1

WEIGHT, KG	
Bearing	ES203
Housing	C203

#### MANUFACTURER

[SNR](#)

#### INTERCHANGE

ABC

[ESC203](#)

#### CALCULATION DATA

Basic dynamic load rating, C	9,550 kN
Basic static load rating, Co	4,780 kN
Operating temperature min	-20 °C
Operating temperature max	110 °C