

ESC204 ABC

Ball bearing units

TYPE: Housing units, Cartridge units, Cast iron housing, Radial insert ball bearing with eccentric locking collar, With inner ring extended at one side

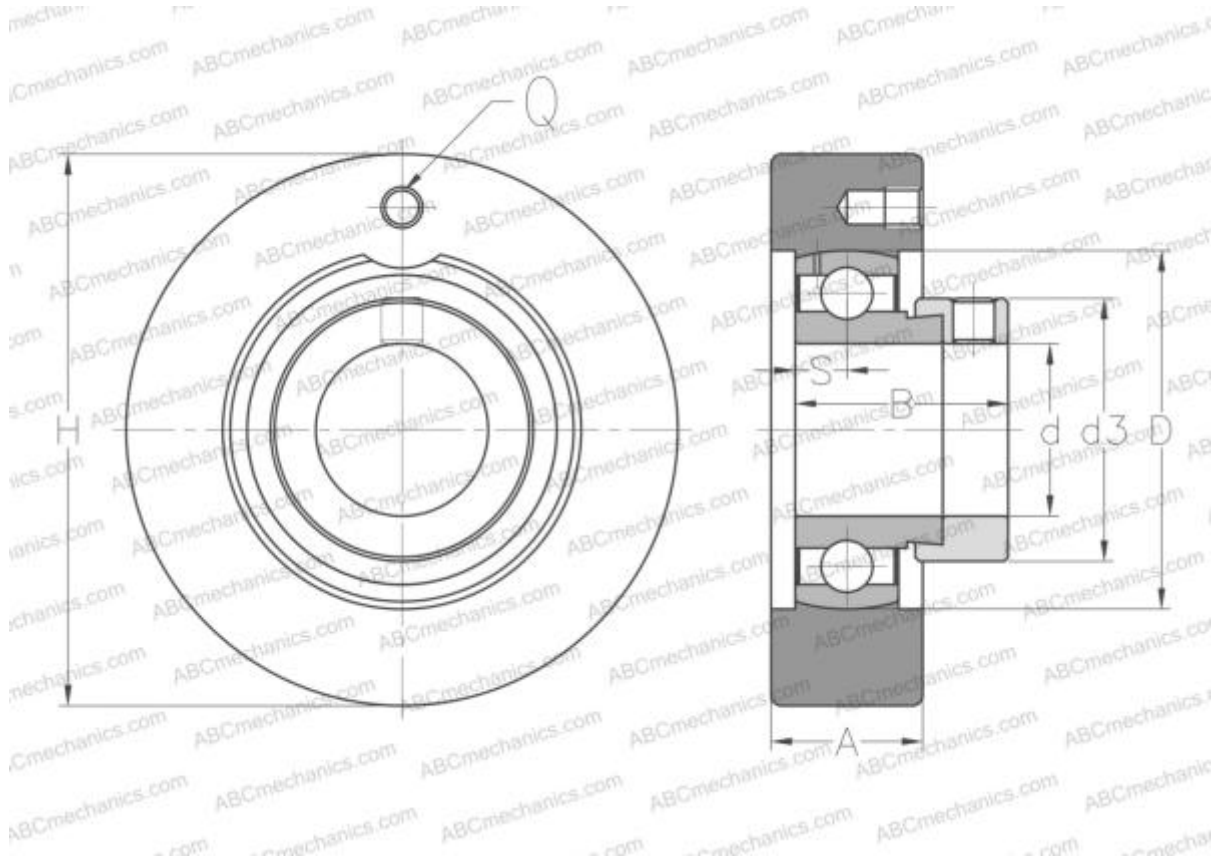

Technical specification

DIMENSIONS, MM

d	20,000
D	47,000
B	30,900
H	72,000
A	20,000
S	7,500
d3	33,300
Q	M6x1

WEIGHT, KG	0,500
Bearing	ES204
Housing	C204

MANUFACTURER

[ABC](#)

INTERCHANGE

SNR

[ESC204](#)