

EXC205 ABC

Ball bearing units

TYPE: Housing units, Cartridge units, Cast iron housing, Radial insert ball bearing with eccentric locking collar, With inner ring extended on both sides

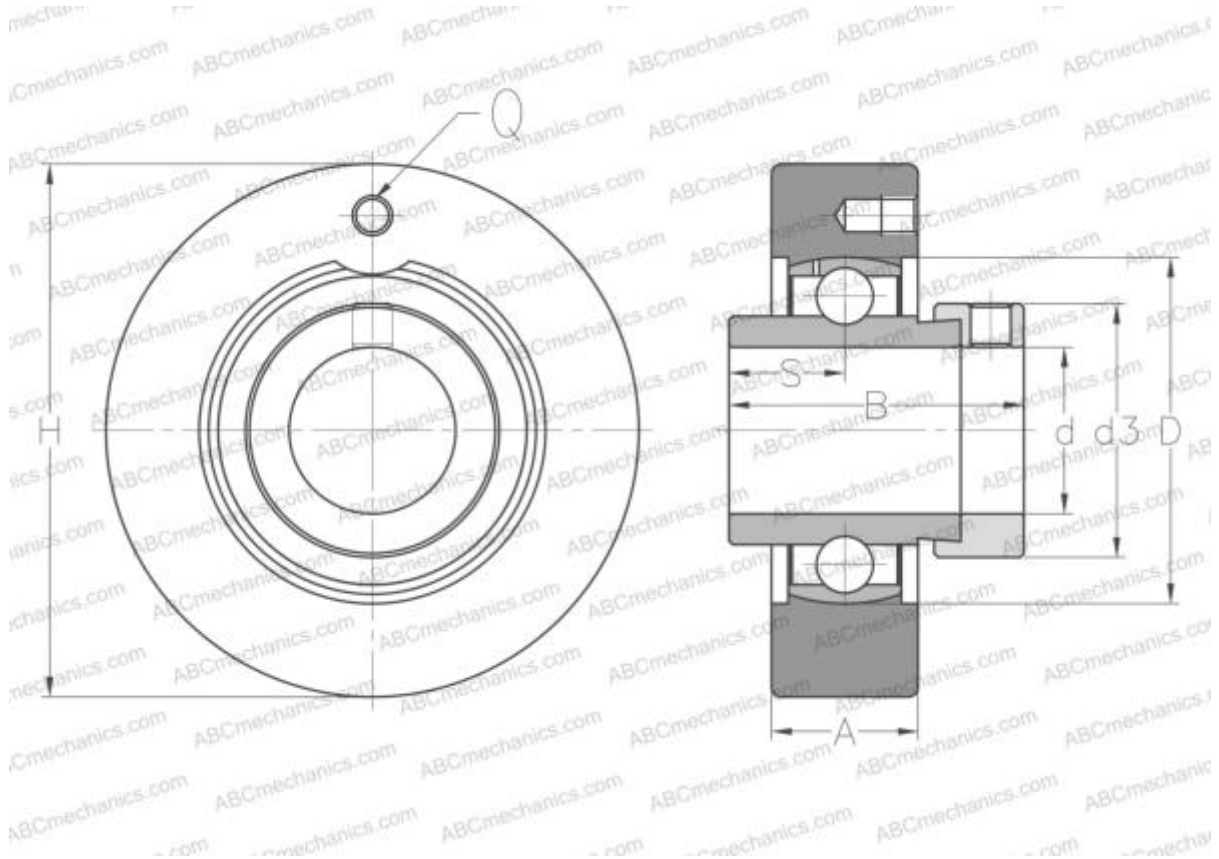

Technical specification

DIMENSIONS, MM

d	25,000
D	52,000
B	44,300
H	80,000
A	22,000
S	17,400
d3	38,100
Q	M6x1

WEIGHT, KG

Bearing	EX205
Housing	C205

MANUFACTURER

[ABC](#)

INTERCHANGE

SNR

[EXC205](#)