

USC201 ABC

Ball bearing units

TYPE: Housing units, Cartridge units, Cast iron housing, Radial insert ball bearing with grub screws in inner ring, With inner ring extended at one side

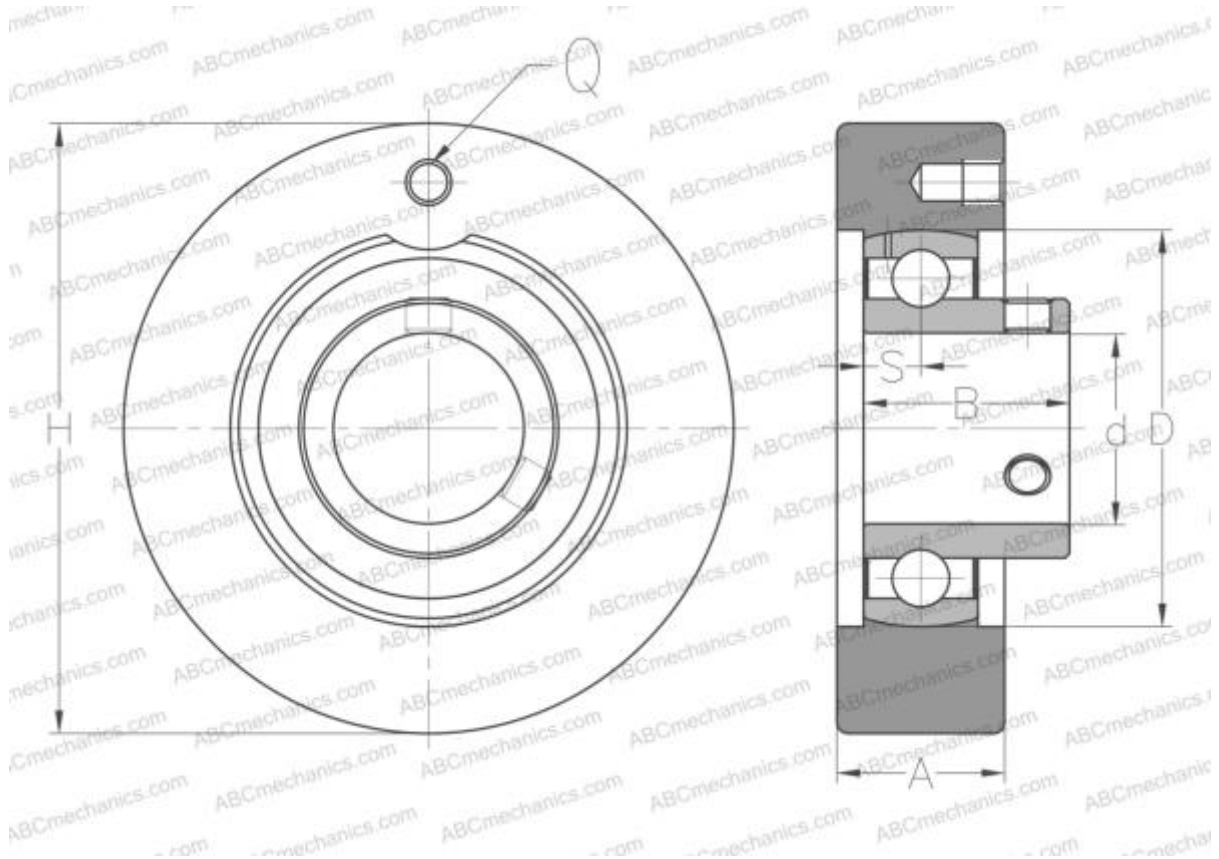

Technical specification

DIMENSIONS, MM

d	12,000
D	40,000
B	22,000
H	67,000
A	20,000
S	6,000
Q	M6x1

WEIGHT, KG

	0,400
Bearing	US201
Housing	C203

MANUFACTURER

[ABC](#)

INTERCHANGE

SNR	USC201
-----	------------------------