

## USC204 ABC

Ball bearing units

TYPE: Housing units, Cartridge units, Cast iron housing, Radial insert ball bearing with grub screws in inner ring, With inner ring extended at one side

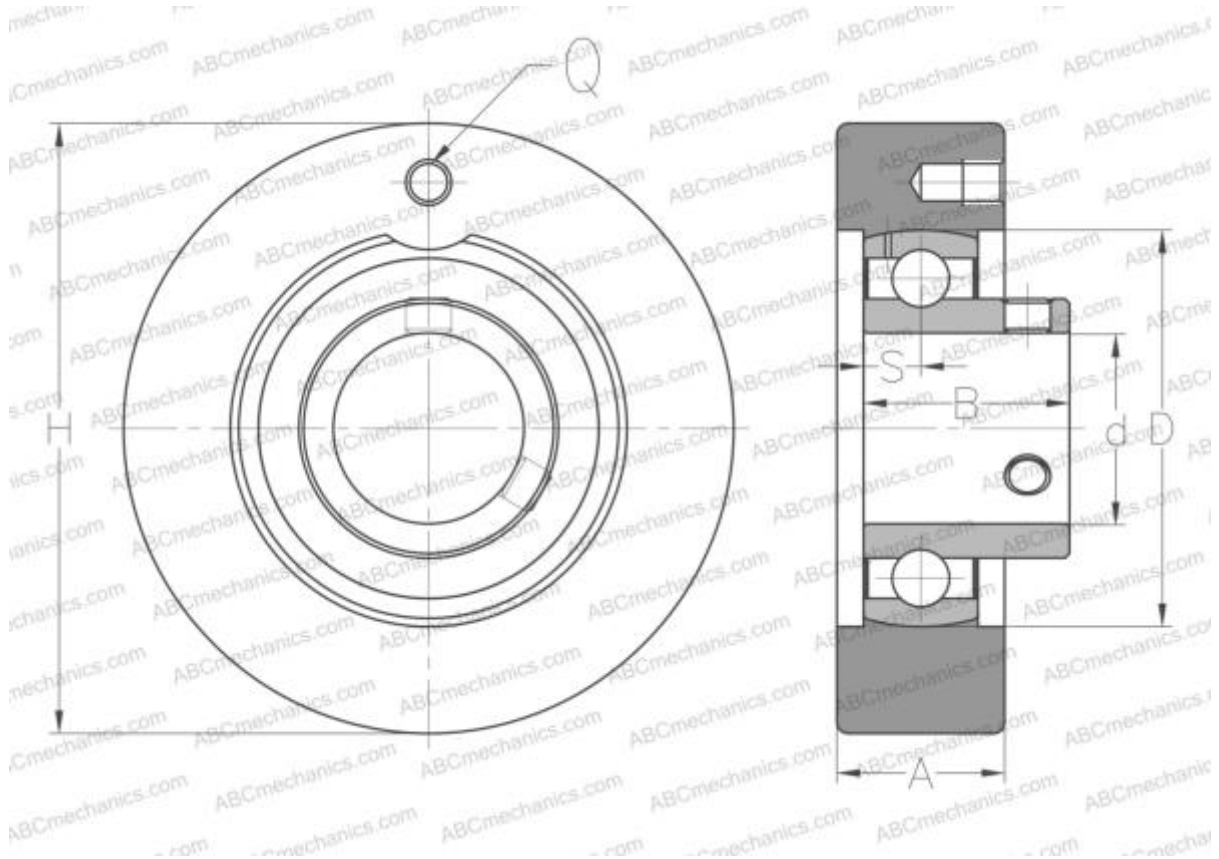

### Technical specification

#### DIMENSIONS, MM

d	20,000
D	47,000
B	25,000
H	72,000
A	20,000
S	7,000
Q	M6x1

<b>WEIGHT, KG</b>	0,500
Bearing	US204
Housing	C204

**MANUFACTURER** [ABC](#)

#### INTERCHANGE

SNR [USC204](#)