

USC205 ABC

Ball bearing units

TYPE: Housing units, Cartridge units, Cast iron housing, Radial insert ball bearing with grub screws in inner ring, With inner ring extended at one side

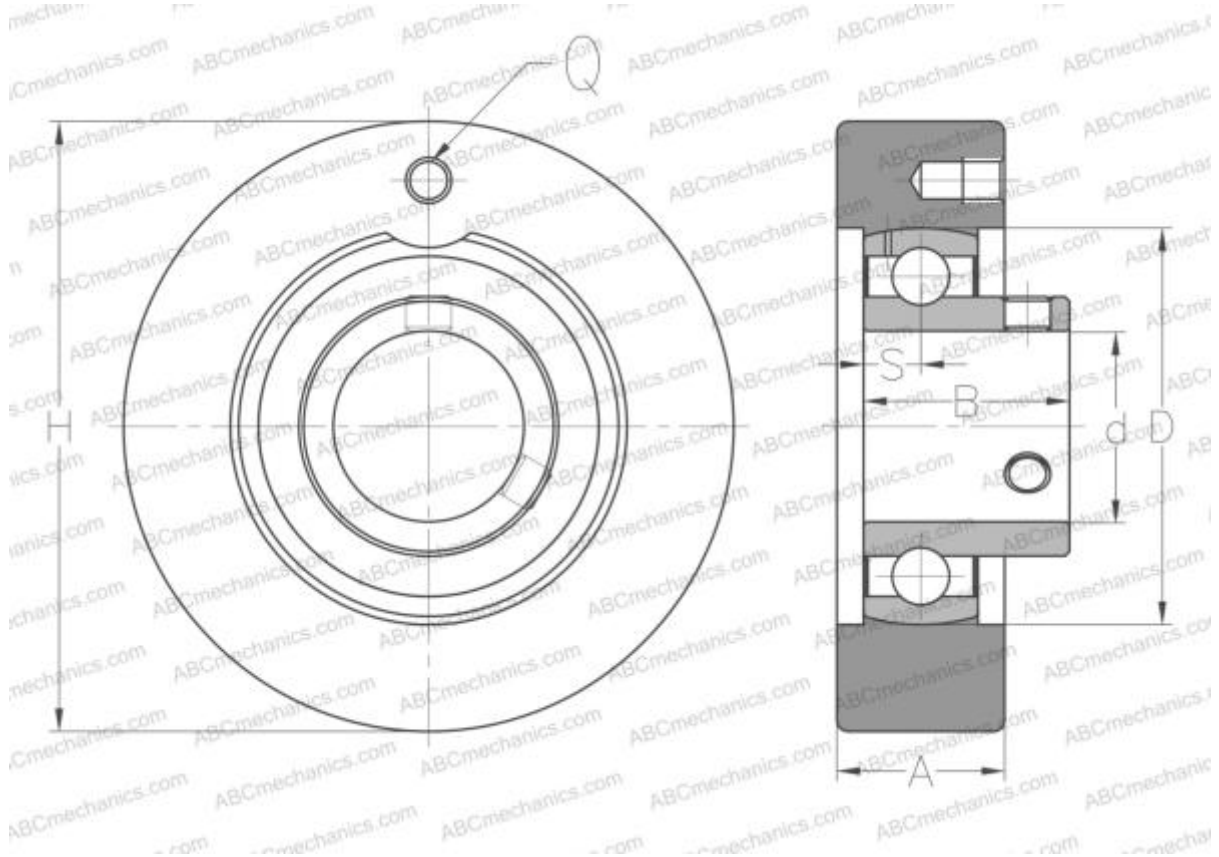

Technical specification

DIMENSIONS, MM

d	25,000
D	52,000
B	27,000
H	80,000
A	22,000
S	7,500
Q	M6x1

WEIGHT, KG	0,700
Bearing	US205
Housing	C205

MANUFACTURER [ABC](#)

INTERCHANGE

SNR	USC205
-----	------------------------