

UKC305H ABC

Ball bearing units

TYPE: Housing units, Cartridge units, Cast iron housing, Radial insert ball bearing with adapter sleeve, With inner ring extended on both sides

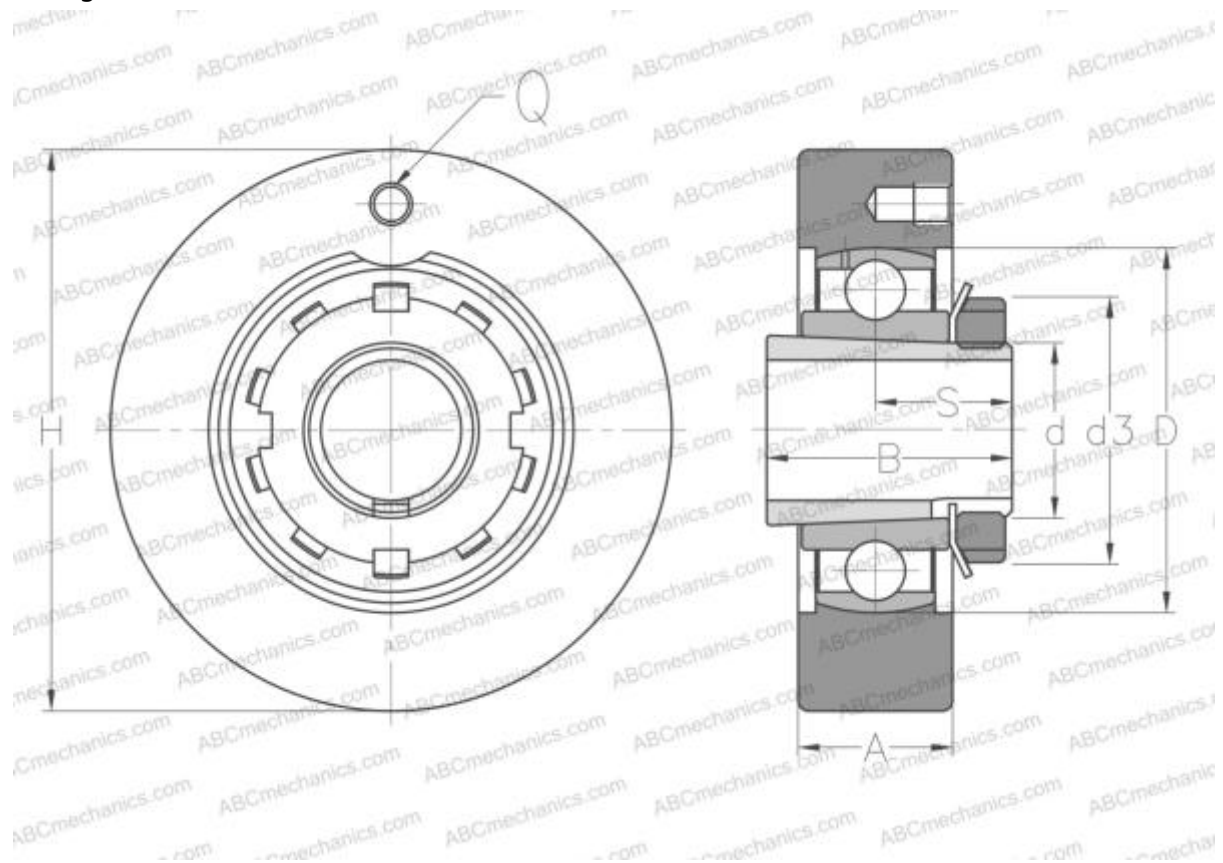

Technical specification

DIMENSIONS, MM

d	20,000
D	62,000
B	35,000
H	90,000
A	26,000
S	21,500
d3	38,000
Q	M6x1

WEIGHT, KG

1,500

Bearing	UK305 +
Housing	C305
Adapter sleeve	H2305

MANUFACTURER

[ABC](#)

INTERCHANGE

SNR

[UKC305H](#)