

SESPA203 SNR

Ball bearing units

TYPE: Housing units, Plummer block, Narrow cast iron housing, Radial insert ball bearing with eccentric locking collar, With inner ring extended at one side, wide base, massive bearing units, stainless steel

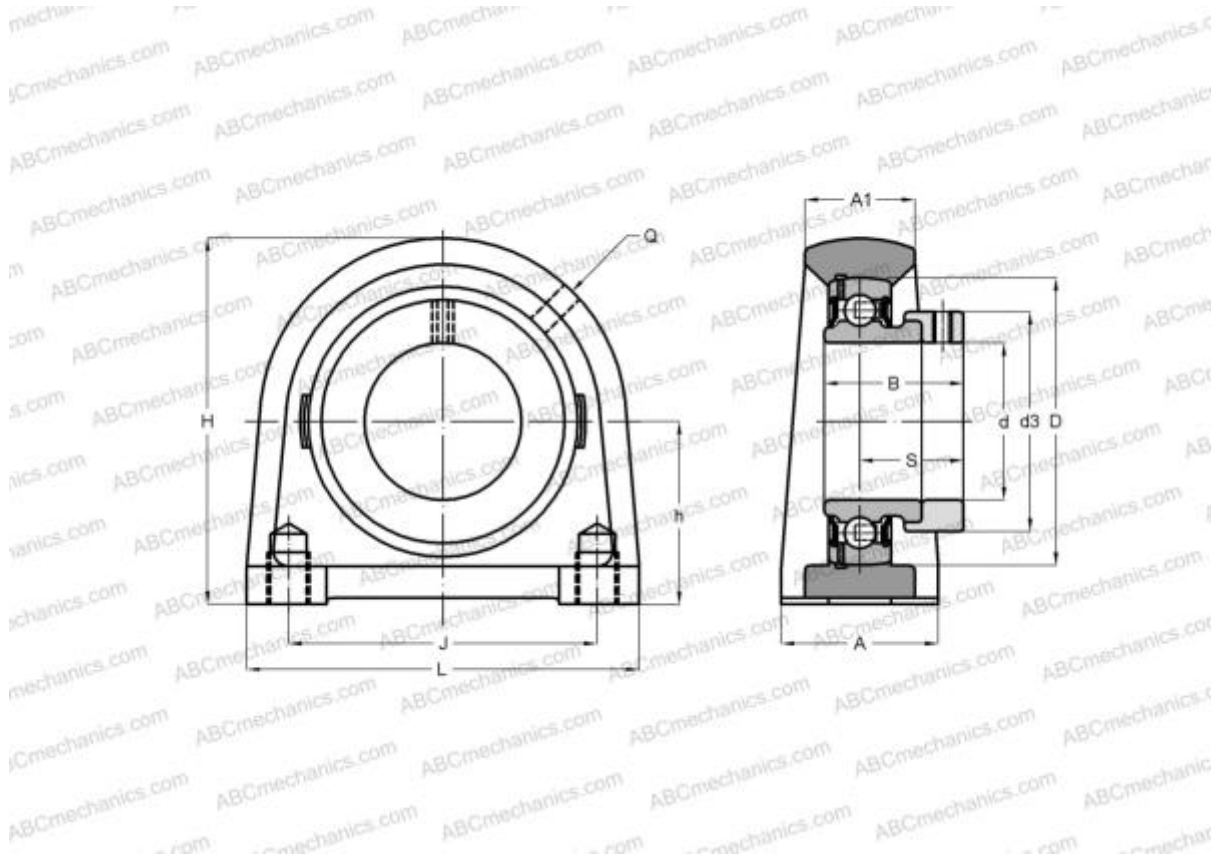

Technical specification

DIMENSIONS, MM

d	17,000
D	40,000
B	28,600
L	73,000
H	62,000
A	38,000
J	50,800
H1	11,000
S	22,600
d3	28,600
h	30,200
m	M8

WEIGHT, KG 0,630

Bearing	SES203
Housing	SPA204

MANUFACTURER

[SNR](#)

INTERCHANGE

ABC	SESPA203
-----	--------------------------

CALCULATION DATA

Operating temperature min	-20 °C
Operating temperature max	120 °C