

## SESPA205-16 SNR

Ball bearing units

TYPE: Housing units, Plummer block, Narrow cast iron housing, Radial insert ball bearing with eccentric locking collar, With inner ring extended at one side, wide base, massive bearing units, stainless steel, inch size

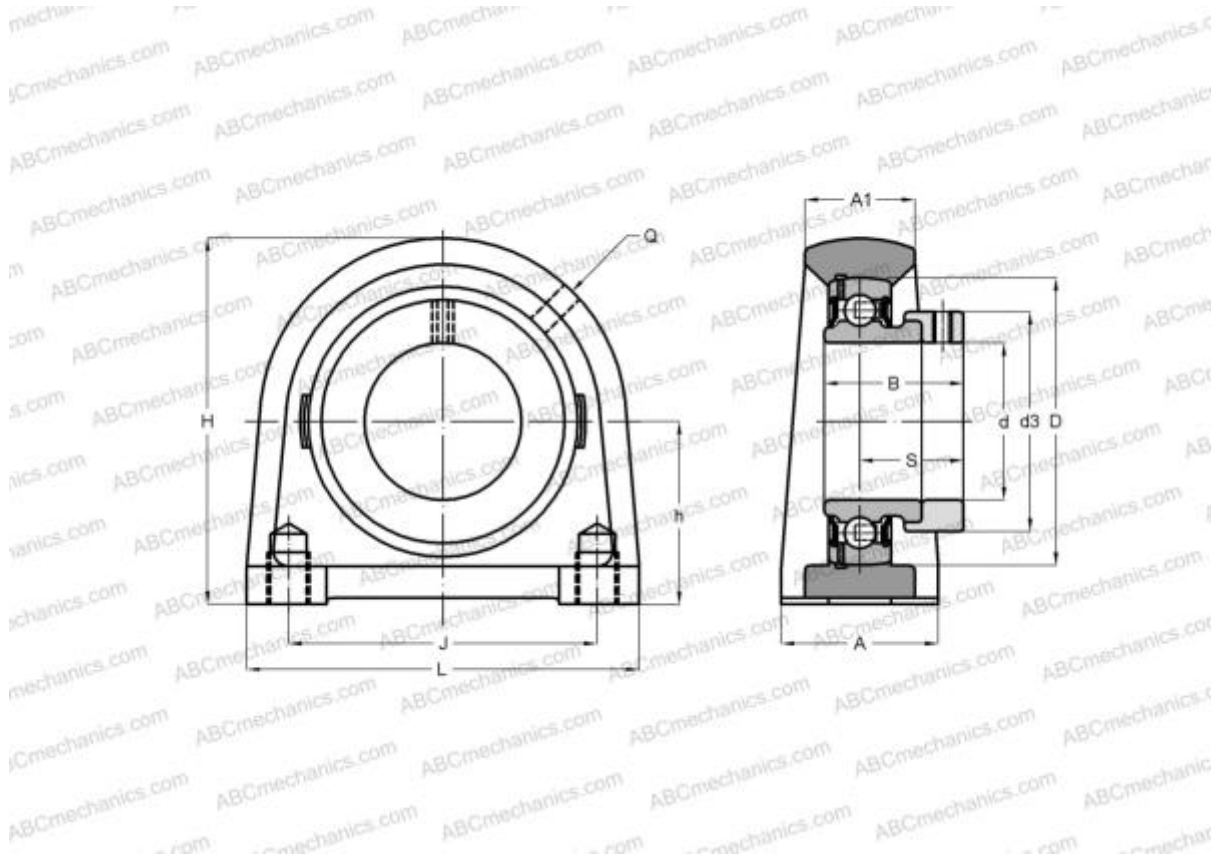

### Technical specification

#### DIMENSIONS, MM

d	25,400
D	52,000
B	31,000
L	76,000
H	71,000
A	38,000
J	50,800
H1	11,000
S	23,500
d3	38,100
h	36,500
m	M10

**WEIGHT, KG** 0,780

Bearing	SES205-16
Housing	SPA205

**MANUFACTURER** [SNR](#)

#### INTERCHANGE

ABC [SESPA205-16](#)

#### CALCULATION DATA

Operating temperature min	-20 °C
Operating temperature max	120 °C