

## SEST206-20 SNR

Ball bearing units

TYPE: Housing units, Take-up housing units, Cast iron housing, Radial insert ball bearing with eccentric locking collar, With inner ring extended at one side, for tensioning frame, stainless steel, inch size

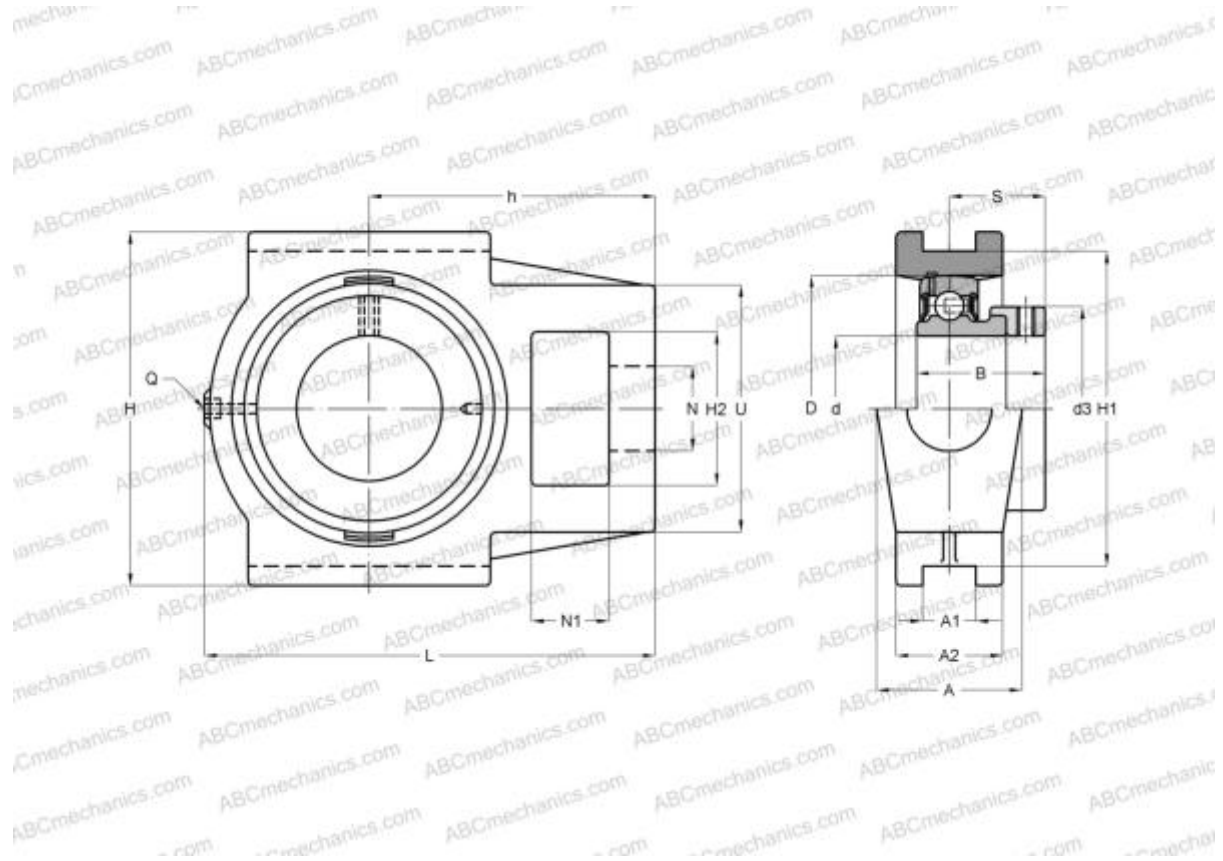

### Technical specification

#### DIMENSIONS, MM

d	31,750
D	62,000
B	35,700
L	113,000
H	102,000
A	37,000
H2	37,000
A1	12,000
A2	28,000
H1	89,000
N	22,000
N1	16,000
S	27,700
d3	44,500
U	56,000

#### DIMENSIONS, MM

h	70,000
---	--------

#### WEIGHT, KG

Bearing	SES206-20
Housing	ST206

#### MANUFACTURER

[SNR](#)

#### CALCULATION DATA

Operating temperature min	-20 °C
Operating temperature max	120 °C