

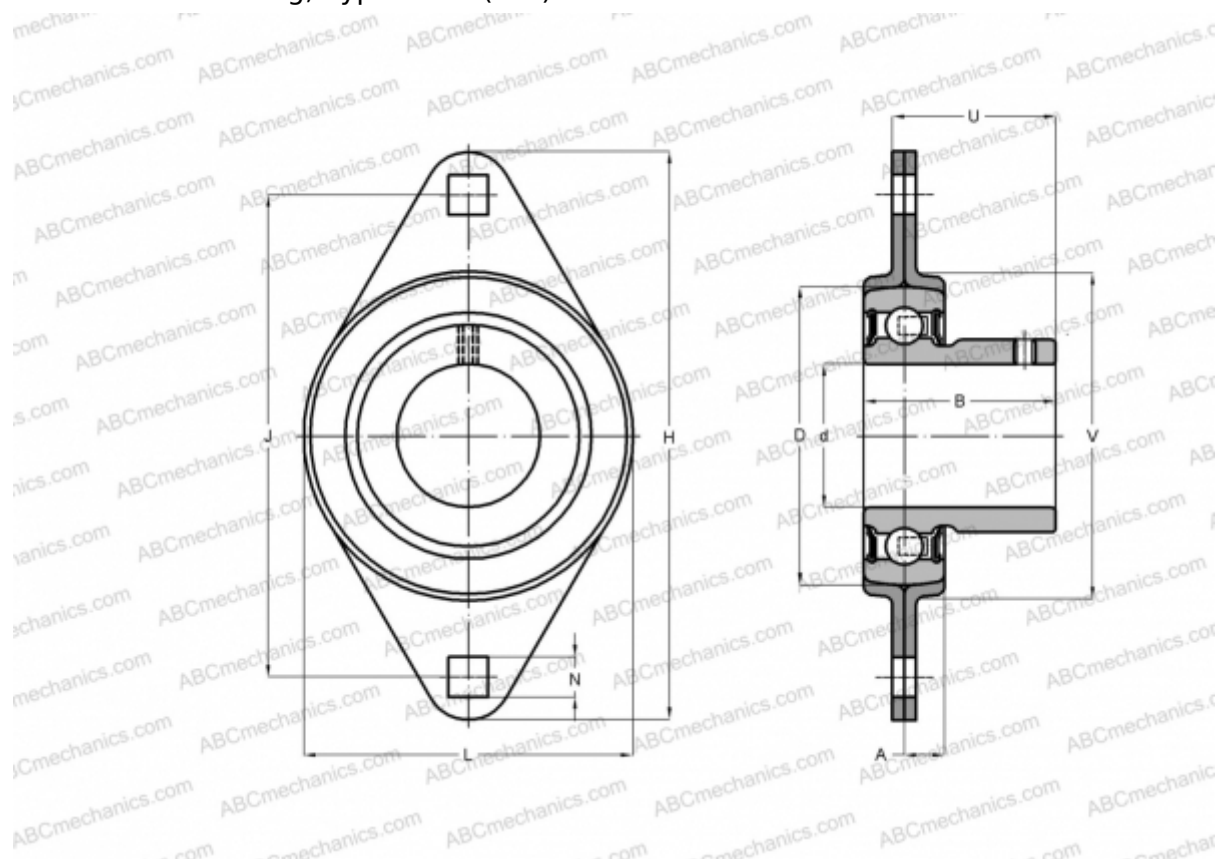

## RATY35 INA

Ball bearing units

TYPE: Housing units, Two-bolt flanged housing units, Sheet steel housing, Radial insert ball bearing with grub screws in inner ring, Type RATY (INA)



### Technical specification

#### DIMENSIONS, MM

d	35,000
D	72,000
B	35,000
L	93,700
H	123,000
A	10,500
J	100,000
N	10,500
U	28,000
V	81,000

**WEIGHT, KG** 0,560

Bearing	GAY35-NPP-B
Housing	FLAN72-MST x

#### MANUFACTURER

[INA](#)

#### INTERCHANGE

INA FLAN72-MST x 2 + GAY35-NPP-B