

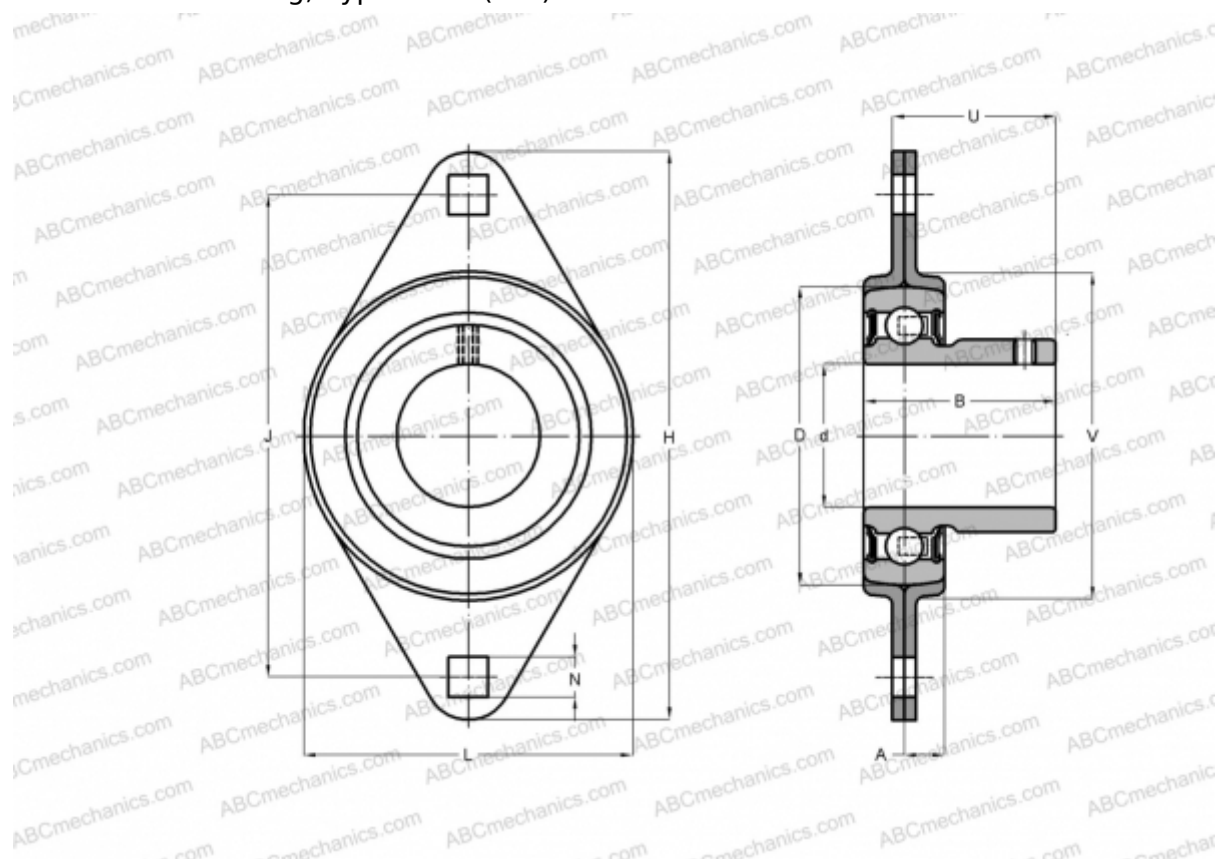

RATY40 INA

Ball bearing units

TYPE: Housing units, Two-bolt flanged housing units, Sheet steel housing, Radial insert ball bearing with grub screws in inner ring, Type RATY (INA)



Technical specification

DIMENSIONS, MM

d	40,000
D	80,000
B	39,500
L	100,000
H	151,000
A	11,500
J	119,000
N	13,500
U	32,500
V	90,000

WEIGHT, KG

0,850

MANUFACTURER

[INA](#)

INTERCHANGE

INA

FLAN80-MST x 2 + GAY40-NPP-B

Bearing

GAY40-NPP-B

Housing

FLAN80-MST x

2